

WINCHESTER CITY COUNCIL

TOWN AND COUNTRY PLANNING ACT 1990 - SECTION 257

The Winchester City (Parish of Newlands)
(Part of Footpath 732 (West) Newlands)
Public Path Diversion Order 2025

This Order is made by Winchester City Council under section 257 of the Town and Country Planning Act 1990 because it is satisfied that it is necessary to divert a part of the footpath to which this Order relates in order to enable development to be carried out in accordance with planning permission granted under Part III of the Town and Country Planning Act 1990 under planning reference 10/02862/OUT at Newlands, Hambledon Road, Denmead, Hampshire.

BY THIS ORDER

1. The section of the footpath over the land shown by a bold black line on the attached map and described in Part 1 of the Schedule to this Order shall be diverted as provided below.
2. There shall be created to the reasonable satisfaction of Winchester City Council an alternative section of highway for use as a replacement for the said footpath as provided in Part 2 of the Schedule and shown by bold black dashes on the attached map.
3. The diversion of the part of the footpath shall have effect on the date on which Winchester City Council certify that the terms of Article 2 above have been complied with.
4. Works to be carried out in relation to the highway described in Part 2 of the Schedule include those works detailed in Part 3 of the Schedule.
5. The applicant is hereby required to pay the cost of creating the section of alternative highway referred to in Article 2 above.
6. Where immediately before the date on which the footpath is diverted there is any apparatus under, in, on, over, along, or across it belonging to statutory undertakers for the purpose of carrying on their undertaking, then the undertakers shall continue to have the rights in respect of the apparatus as they then had.

Given under the Common Seal of Winchester City Council this 15th day of December 2025

**THE COMMON SEAL of
WINCHESTER CITY COUNCIL**
was hereunto affixed
in the presence of

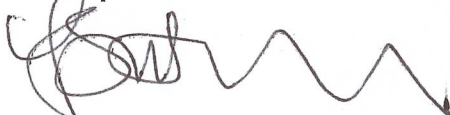

Public Law Manager



SCHEDULE

Part 1

Description of site of section of existing path

From point A- 466708.77/108682.16 to point C- 466543.30/108574.81

The section of footpath shown running A-C on the attached map, drawing reference GTWVILLE_PROW/LG/21 Rev. B, having an overall distance of 198 metres and a width of circa. 2-3 metres.

Part 2

Description of site of section of alternative highway

From point A- 466708.77/108682.16 to point D- 466583.80/108735.93

The diverted route of footpath starting at terminal point E 466708.77, N 108682.16 (point A), continuing north then west, crossing Marrelsmoor Avenue at the formal crossing point. This crossing includes a culvert feature designed to allow passage for great crested newts (and other amphibians) beneath the western link road. The route then continues west to connect to Footpath Newlands 729 on the Multi-Use Greenway at terminal point E 466583.80, N 108735.93 (point D) as shown on the attached map, drawing reference GTWVILLE_PROW/LG/21 Rev. B.

The overall distance of the diverted route is 193 metres with a width circa 2-3 metres.

	Terminal Points		Length (metres)	Width (metres)
	From:	To:		
1 (A)	E 466708.77 N 108682.16	E 466692.18 N 108712.40	35	2m
2	E 466692.18 N 108712.40	E 466692.35 N 108738.59	26	2m
3	E 466692.35 N 108738.59	E 466695.26 N 108749.36	11	2m
4	E 466695.26 N 108749.36	E 466687.09 N 108751.21	8	3m
5	E 466687.09 N 108751.21	E 466684.57 N 108743.63	8	3m
6	E 466684.57 N 108743.63	E 466680.74 N 108744.45	4	3m
7	E 466680.74 N 108744.45	E 466666.75 N 108744.05	14	3m
8	E 466666.75 N 108744.05	E 466643.97 N 108736.52	24	3m
9	E 466643.97 N 108736.52	E 466612.94 N 108729.85	32	3m

10	E 466612.94 N 108729.85	E 466601.57 N 108730.70	12	3m
11(D)	E 466601.57 N 108730.70	E 466583.80 N 108735.93	19	3m
			193	

Part 3 Description of works

Staggered gates will be installed at the following terminal points: E 466680.11, N 108743.03 and E 466678.77, N 108745.98 as shown on attached maps, drawing references GTWVILLE_PROW/RD/102 and GTWVILLE_PROW/CD/2501 Rev. A.

Part of the route will follow Marrelsmoor Avenue, consisting of a 2m tarmac path. At the crossing (starting terminal point E 466695.26, N 108749.36) the route will widen to 3m, transitioning to a hoggin surfaced footpath to link into the existing hoggin surfaced footpath of the Multi-Use Greenway which is Newlands 729.

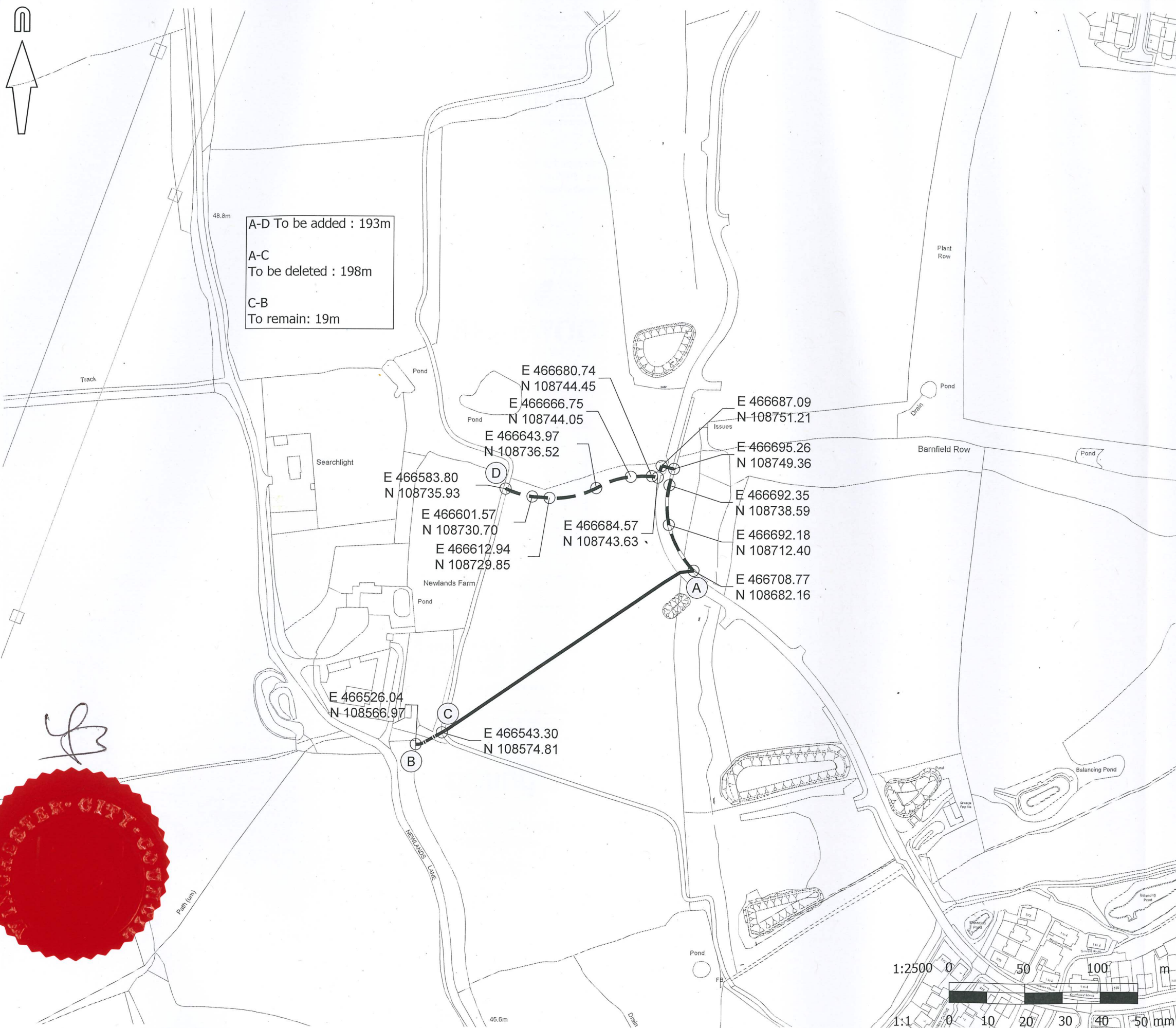

© Mayer Brown Limited Copyright. The drawings, information and data recorded in this document ("the information") is the property of Mayer Brown. This document and the information are solely for the use of the authorised recipient and this document may not be used, copied or reproduced in whole or part for any purposes other than which it was supplied by Mayer Brown. Mayer Brown makes no representation, undertakes no duty and accepts no responsibilities to any third party who may use or rely upon this document or the information.

A3 ORIGINAL

© Crown copyright, all rights reserved. 2025. Licence number 0100031673

KEY:

- FOOTPATH TO BE DELETED FROM THE MAP
- FOOTPATH TO BE REMAIN
- FOOTPATH TO BE ADDED TO THE MAP



FOR INFORMATION
NOT FOR CONSTRUCTION

B	REVISED FOLLOWING CLIENT COMMENTS.	RHA	22/05/2025
A	REVISED FOLLOWING CLIENT COMMENTS.	RHA	19/03/2025
rev.	amendment	checked	date



Mayer Brown Limited Lion House
Oriental Road Woking Surrey GU22 8AR
Telephone 01483 750 508 Fax 01483 750 437
wokingoffice@mayerbrown.co.uk www.mayerbrown.co.uk

client **Investing in homes since 1912**
grainger plc

project
BEREWOOD, WATERLOOVILLE
PUBLIC RIGHTS OF WAY

scale 1:2500 drawn by KD checked by RHA

date JANUARY 2025 cad file LG_09-10-21.dwg

title
PLAN 2:
PROPOSED RIGHT OF WAY DIVERSION
FOOTPATH FP732 WESTERN SECTION

drawing number GTWVILLE_PROW/LG/21 rev. B

© Mayer Brown Limited Copyright. The drawings, information and data recorded in this document ("the information") is the property of Mayer Brown. This document and the information are solely for the use of the authorised recipient and this document may not be used, copied or reproduced in whole or part for any purposes other than which it was supplied by Mayer Brown. Mayer Brown makes no representation, undertakes no duty and accepts no responsibilities to any third party who may use or rely upon this document or the information.

A3 ORIGINAL

© Crown Copyright and database rights 2025 Ordnance Survey 0100031673

NOTES.

- 1) Gates to be precisely set out according to dimensions on Dwg. GTWVILLE_PROW/2501. Gate system to be positioned to avoid foundations clashing with existing fence foundations.

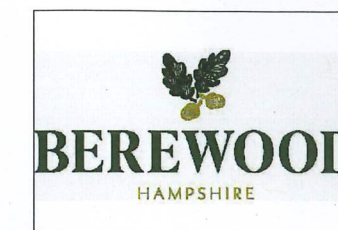

FOR INFORMATION
NOT FOR CONSTRUCTION

rev.	amendment	checked	date



Mayer Brown Limited Lion House
Oriental Road Woking Surrey GU22 8AR
Telephone 01483 750 508 Fax 01483 750 437
wokingoffice@mayerbrown.co.uk www.mayerbrown.co.uk

client **grainger plc** Investing in homes since 1912

project
BEREWOOD, WATERLOOVILLE
PUBLIC RIGHTS OF WAY

scale 1:250 drawn by KD checked by RHA

date MARCH 2025 cad file RD_102.dwg

title
REALIGNMENT OF FP732 - WESTERN SECTION
SWING BARRIER GATES INSTALLATION

drawing number GTWVILLE_PROW/RD/102 rev.

Hinged Lockable Staggered Pedestrian Barriers.
Refer to Dwg. GTWVILLE_PROW/CD/2501

MARRELSMOOR AVENUE

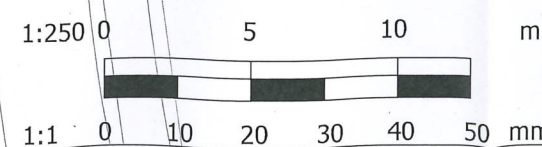

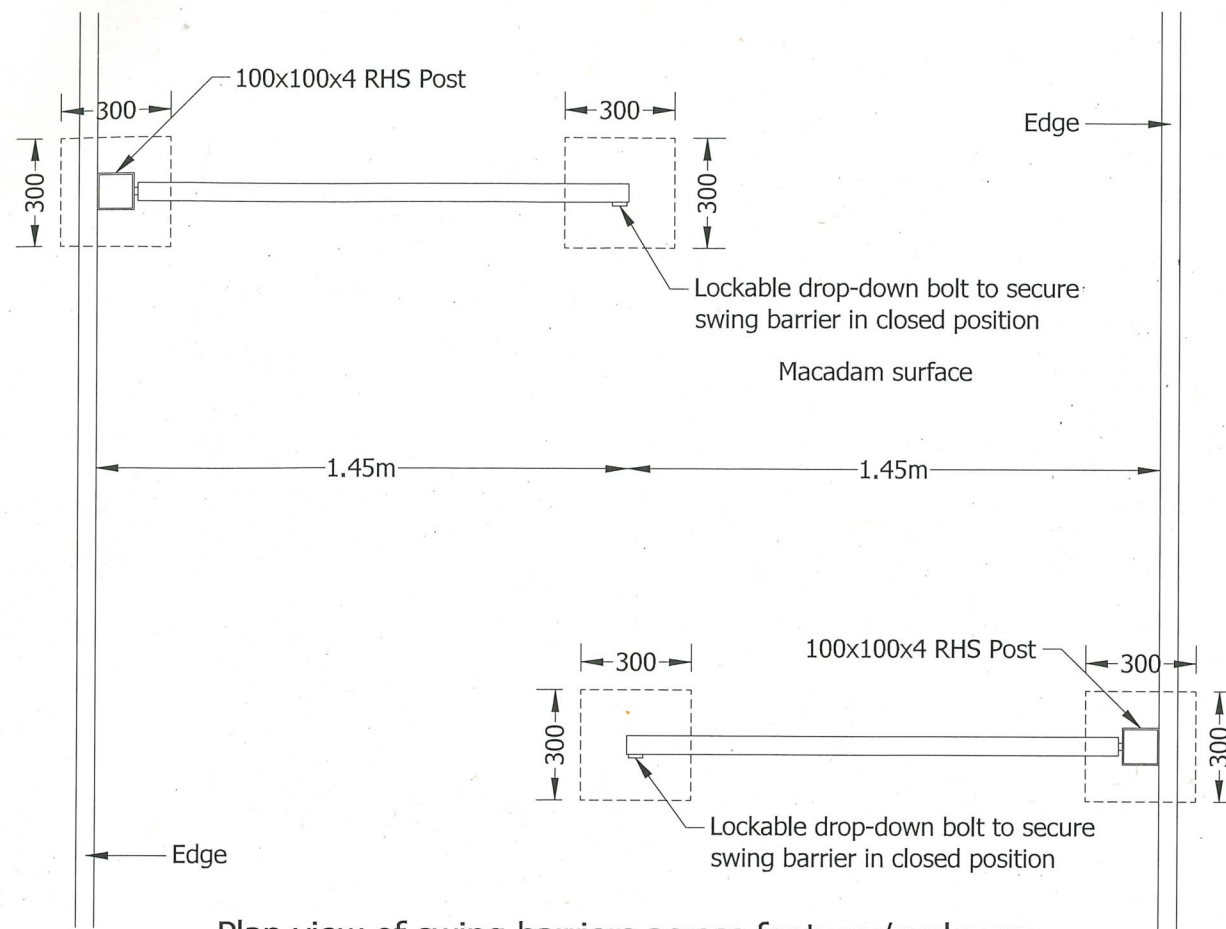

Plan view of swing barriers across footway/cycleway
Scale 1:20

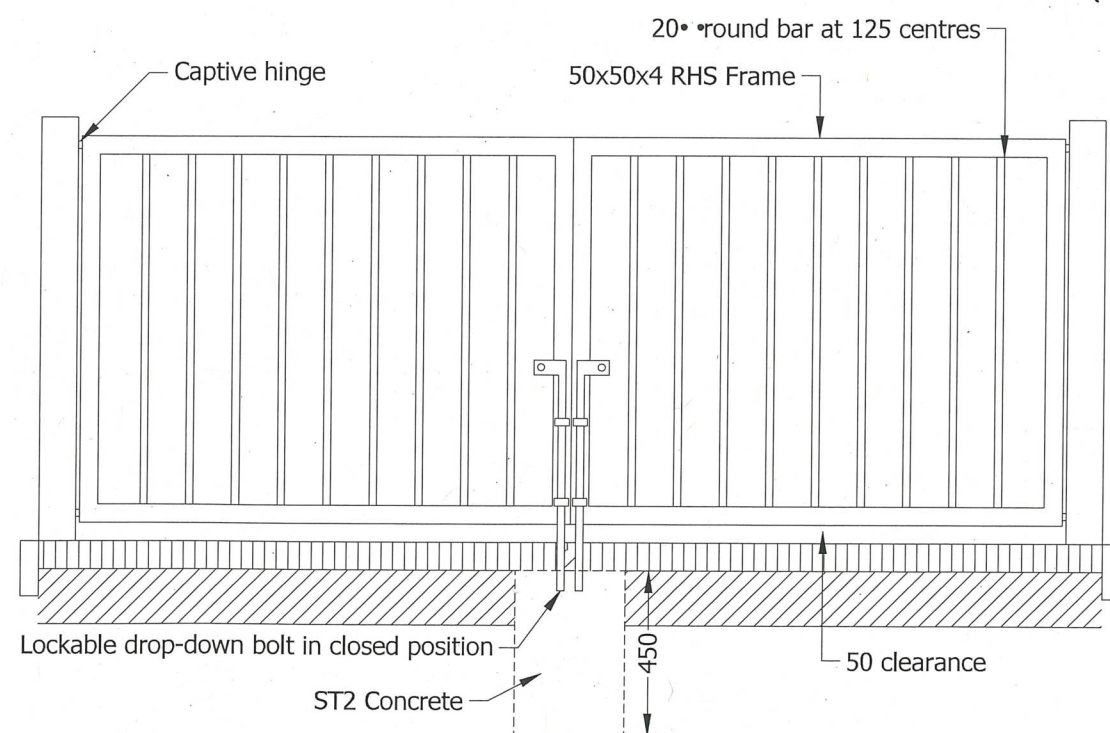

Elevation view of swing barriers across footway/cycleway
Scale 1:20

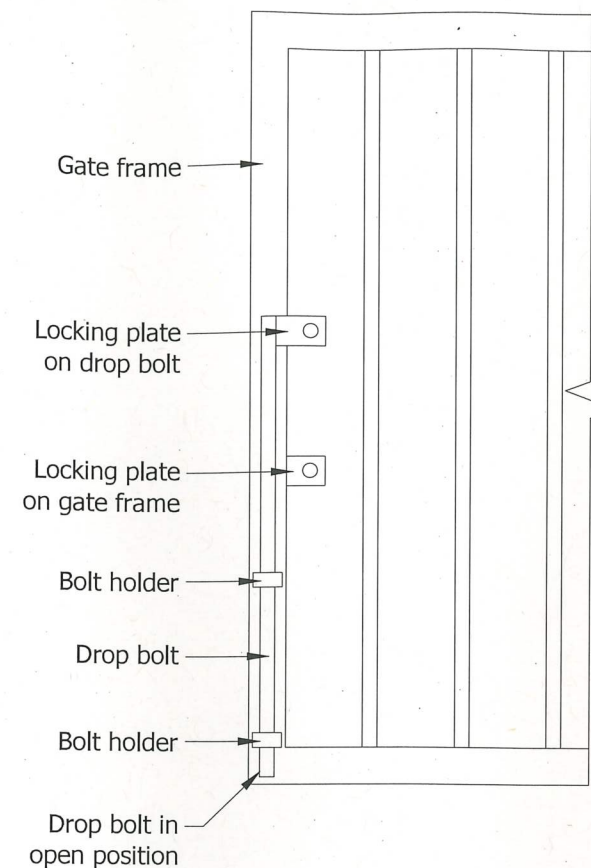
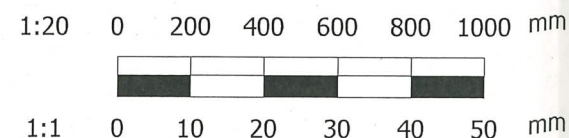

Drop bolt detail
Scale 1:10

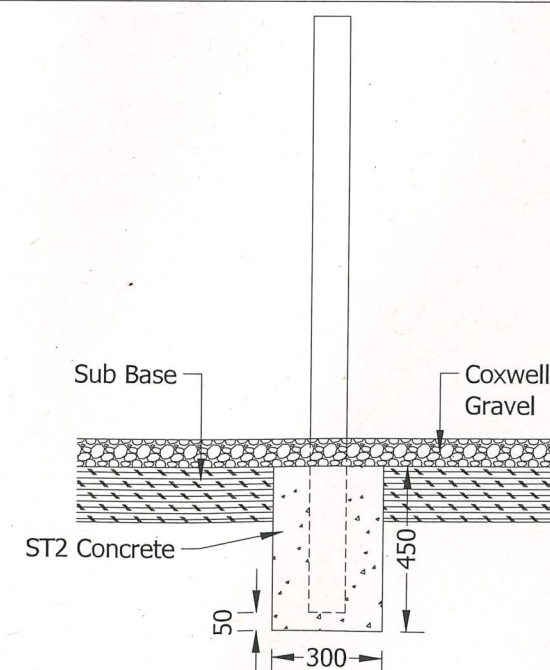

Foundation Detail
Scale 1:20

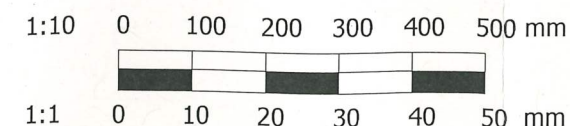

• Mayer Brown Limited Copyright. The drawings, information and data recorded in this document ("the information") is the property of Mayer Brown. This document and the information are solely for the use of the authorised recipient and this document may not be used, copied or reproduced in whole or part for any purposes other than which it was supplied by Mayer Brown. Mayer Brown makes no representation, undertakes no duty and accepts no responsibilities to any third party who may use or rely upon this document or the information.

A3 ORIGINAL

NOTES

- All steel components to be of mild steel to BS1722-9:2006 Hot Dipped Galvanised to BS EN ISO 1461 and powder coated to BS EN 13438. Colour RAL 9005:2006



FOR TENDER
NOT FOR CONSTRUCTION



rev. checked date



Mayer Brown Limited Lion House
Oriental Road Woking Surrey GU22 8AR
Telephone 01483 750 508 Fax 01483 750 437
wokingoffice@mayerbrown.co.uk www.mayerbrown.co.uk

client **grainger plc**

project **BEREWOOD, WATERLOOVILLE
PUBLIC RIGHTS OF WAY**

scale 1:20/1:10 drawn by KD checked by RHA

date JULY 2024 cad file 2501.dwg

title **SWING BARRIER GATES
ACROSS A FOOTWAY/CYCLEWAY**

drawing number **GTWVILLE_PROW/CD/2501** rev. **A**