

NOTES:

All dimensions are to be checked on site prior to construction.
Any discrepancies are to be reported to Philip Hughes Associates for clarification.

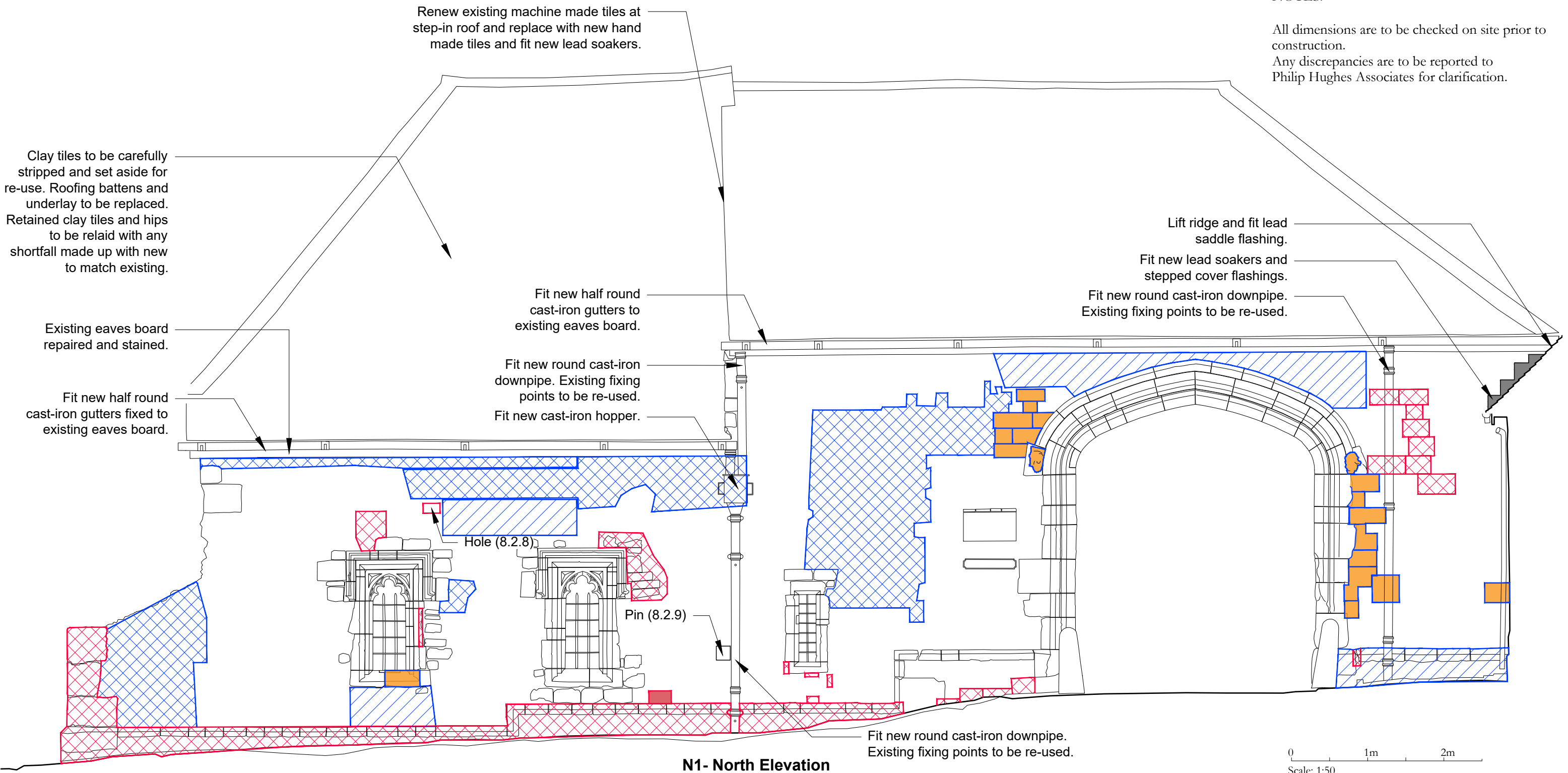

N1- North Elevation

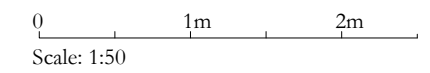

~	04-11-2025	Drawing originated	AT
REV	DATE	NOTES	BY

JOB TITLE
Winchester
Hyde Abbey Gateway

DRAWING TITLE
North Elevation
Repair Works- As Proposed

JOB No	DWG No	REV
632/02	026	~
DRAWN BY	SCALE	DATE
AT	1:50	NOV 2025

PHILIP HUGHES ASSOCIATES
HISTORIC BUILDINGS CONSERVATION CONSULTANTS
OLD MANOR STABLES TOUT HILL WINCANTON SOMERSET BA9 9DL TEL: 01963 824240 FAX: 01963 824642

KEY

Repair	Reference	Hatch
Mixed Stone and Flint areas- Remove cement and re-point	8.2.1	
Stone or Brick areas- Remove cement and re-point	8.2.2	
Flint and/or Stone areas- re-point	8.2.3/8.2.4	
Brick re-point		
Shelter coat face of stone	8.2.5	
Mortar repair decayed stone	8.2.7	
Patch re-point		

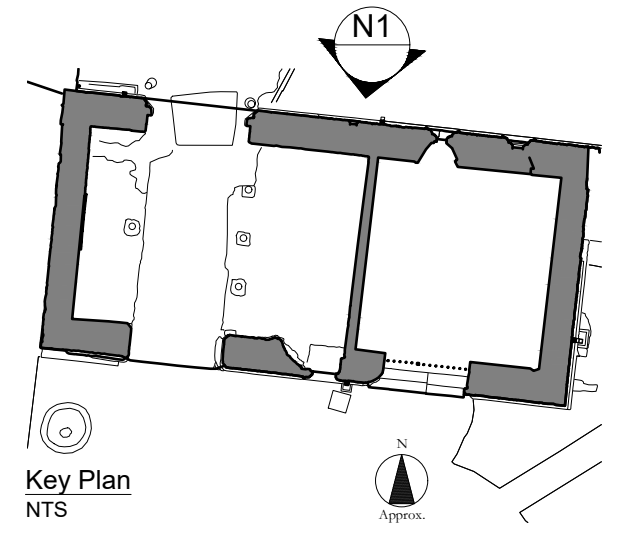

NOTES:
 All dimensions are to be checked on site prior to construction.
 Any discrepancies are to be reported to Philip Hughes Associates for clarification.

Clay tiles to be carefully stripped and set aside for re-use. Roofing battens and underlay to be replaced. Retained clay tiles and hips to be relaid with any shortfall made up with new to match existing.

Existing eaves board repaired and stained.
 Fit new half round cast-iron gutters fixed to existing eaves board.

Renew existing machine made tiles at step-in roof and replace with new hand made tiles and fit new lead soakers.

Fit new round cast-iron downpipes. Existing fixing points to be re-used.
 Fit new cast-iron hopper.

Fit new half round cast-iron gutters fixed to existing eaves board.

Remove redundant light fittings.

New stone to corner plinth (8.3.7).

Remove cement pointing from both reveals and re-point with lime mortar.

Decorate inner and outer gates to enclosed space.

0 1m 2m
 Scale: 1:50

~	04-11-2025	Drawing originated	AT
REV	DATE	NOTES	BY

JOB TITLE
 Winchester
 Hyde Abbey Gateway
 DRAWING TITLE
 South Elevation
 Repair Works- As Proposed

JOB No	DWG No	REV
632/02	027	~
DRAWN BY	SCALE	DATE
AT	1:50	NOV 2025

PHILIP HUGHES ASSOCIATES
 HISTORIC BUILDINGS CONSERVATION CONSULTANTS
 OLD MANOR STABLES TOUT HILL WINCANTON SOMERSET BA9 9DL TEL: 01963 824240 FAX: 01963 824642

S1- South Elevation

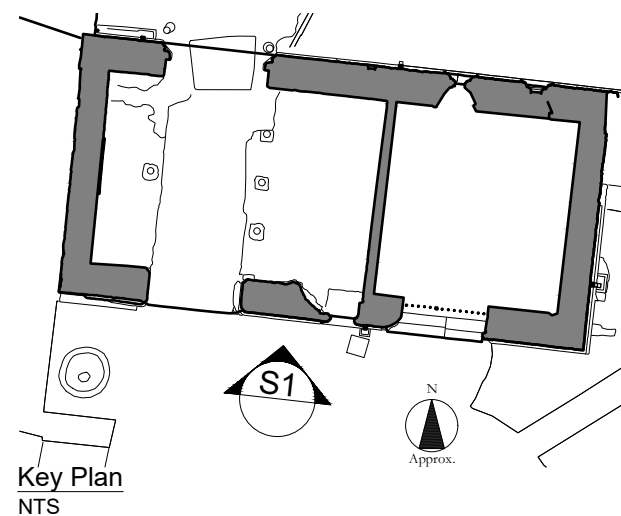

KEY		
Repair	Reference	Hatch
Mixed Stone and Flint areas- Remove cement and re-point	8.3.1	
Stone or Brick areas- Remove cement and re-point	8.3.2	
Flint and/or Stone areas- re-point	8.3.3	
Brick re-point		
Shelter coat face of stone	8.3.4	
Mortar repair decayed stone	8.3.6	
Patch re-point		

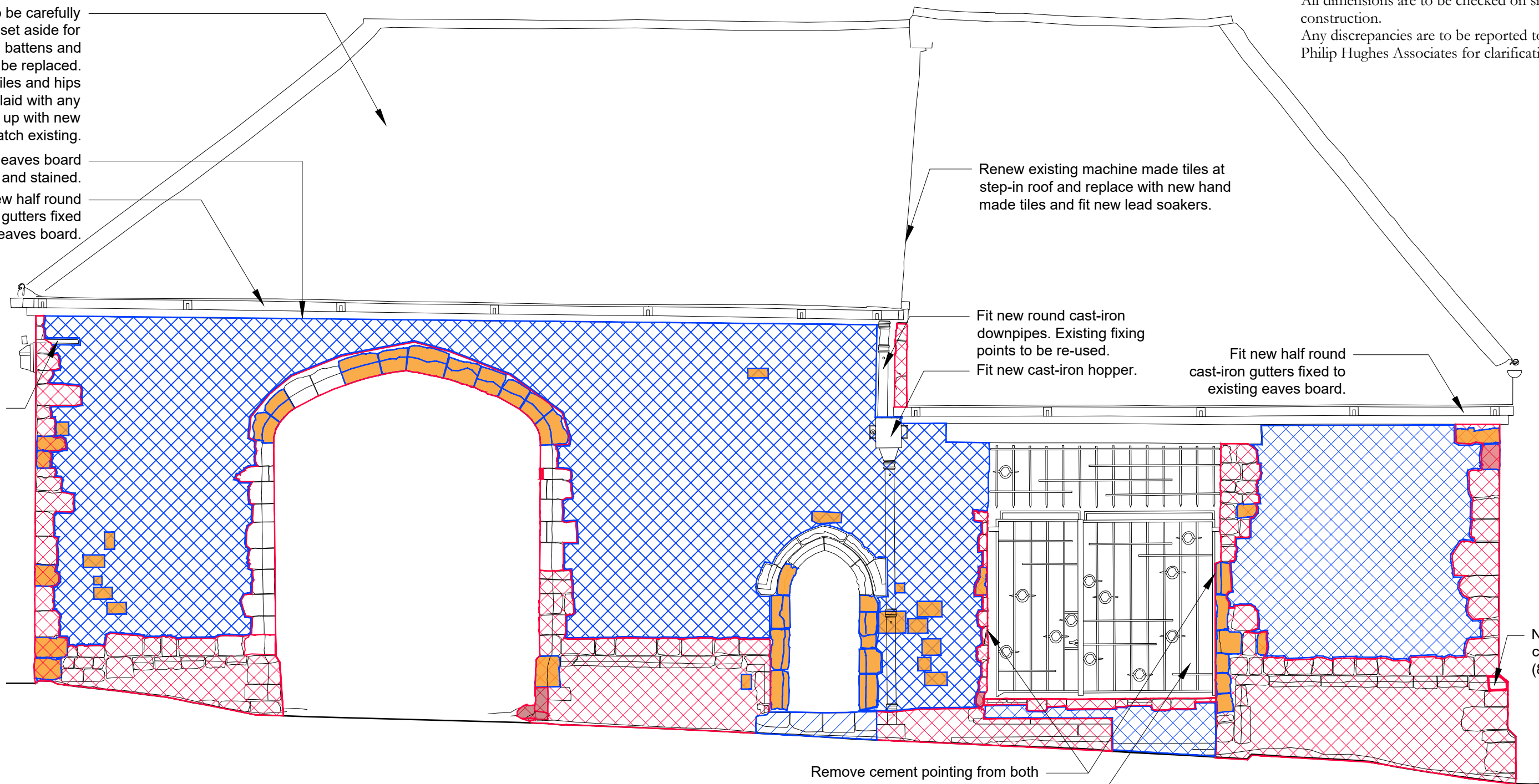

NOTES:
 All dimensions are to be checked on site prior to construction.
 Any discrepancies are to be reported to Philip Hughes Associates for clarification.

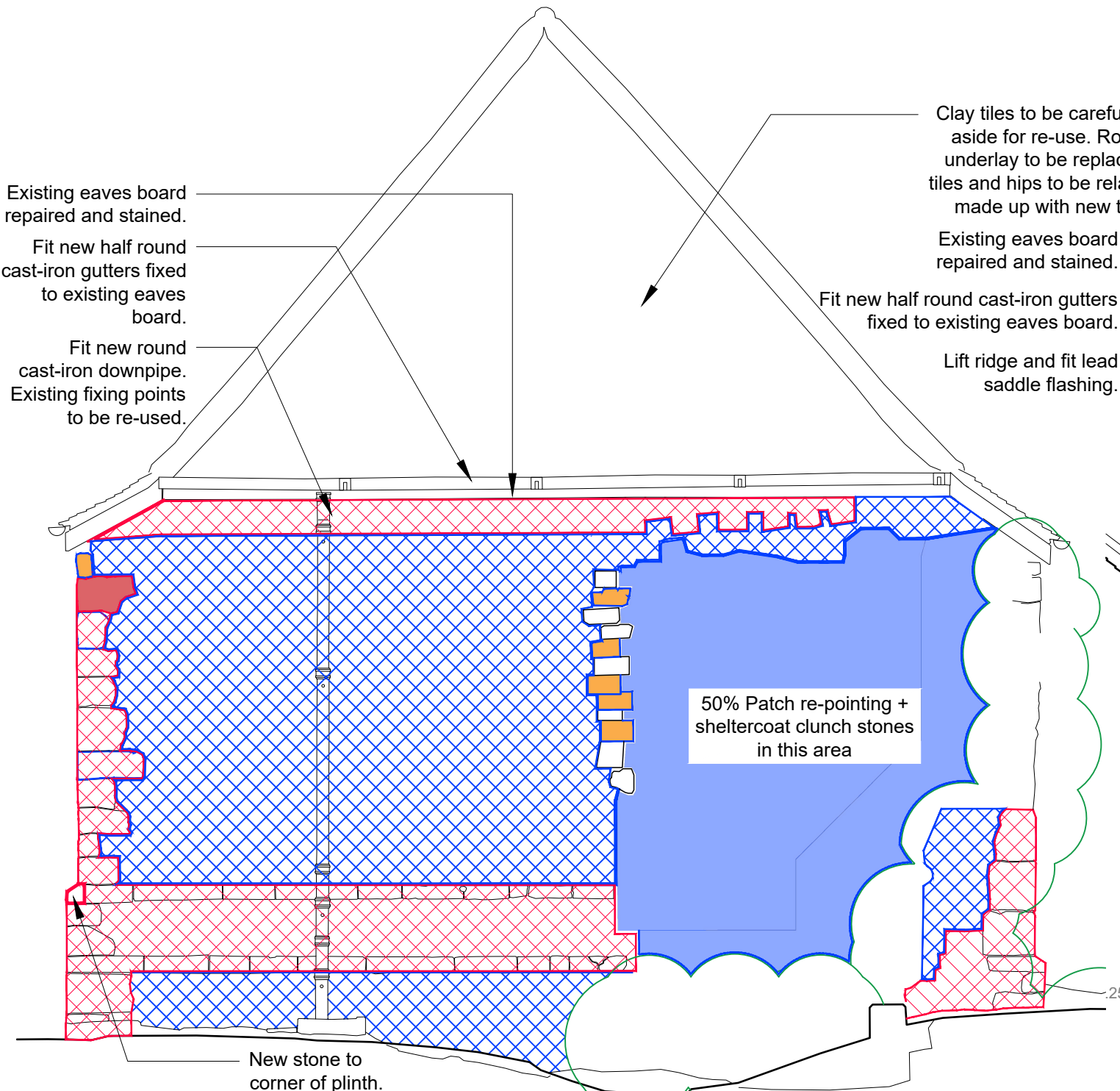

E1- East Elevation

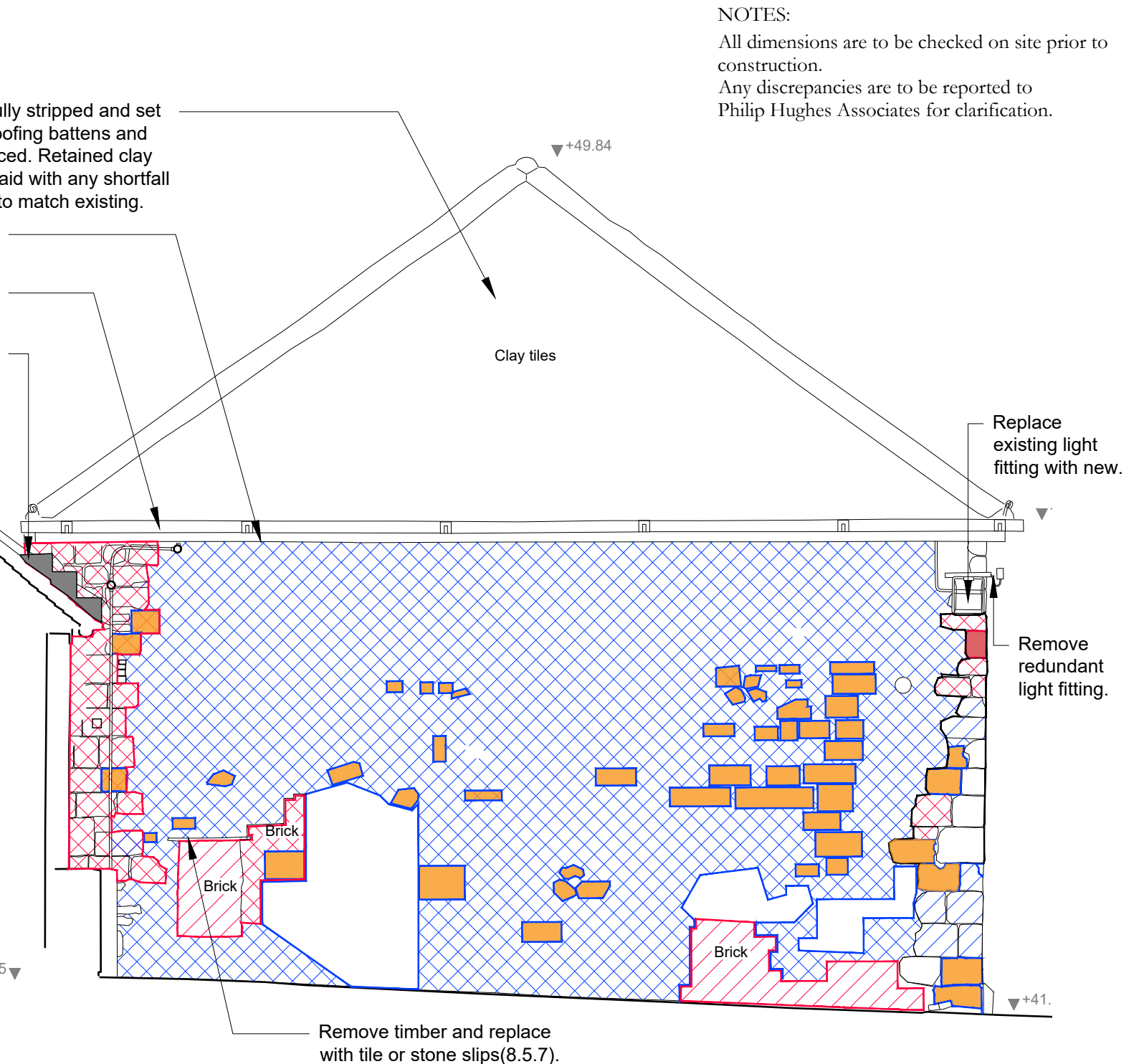

W1- West Elevation

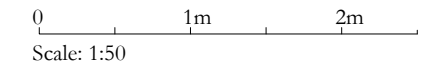

~	04-11-2025	Drawing originated	AT
REV	DATE	NOTES	BY
JOB TITLE			
Winchester			
Hyde Abbey Gateway			
DRAWING TITLE			
East & West Elevation			
Repair Works- As Proposed			
JOB No	DWG No	REV	
632/02	028	~	
DRAWN BY	SCALE	DATE	
AT	1:50/10 at A3	NOV 2025	

KEY			
Repair	Reference (East Elev.)	Reference (West Elev.)	Hatch
Mixed Stone and Flint areas- Remove cement and re-point	8.4.2	8.5.1	
Stone or Brick areas- Remove cement and re-point	8.4.3	8.5.2	
Flint and/or Stone areas- re-point		8.5.3	
Brick re-point		8.5.3	
Shelter coat face of stone	8.4.5	8.5.4	
Mortar repair decayed stone		8.5.6	
Patch re-point	8.4.4		

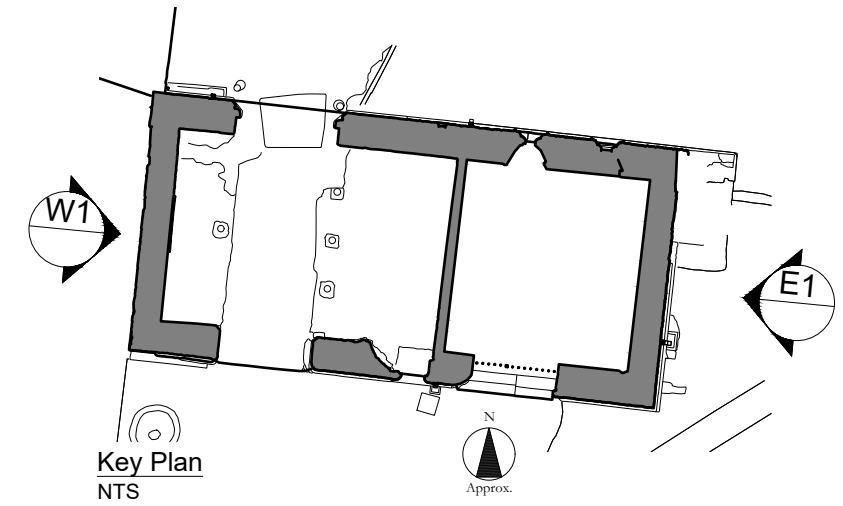

NOTES:
 All dimensions are to be checked on site prior to construction.
 Any discrepancies are to be reported to Philip Hughes Associates for clarification.

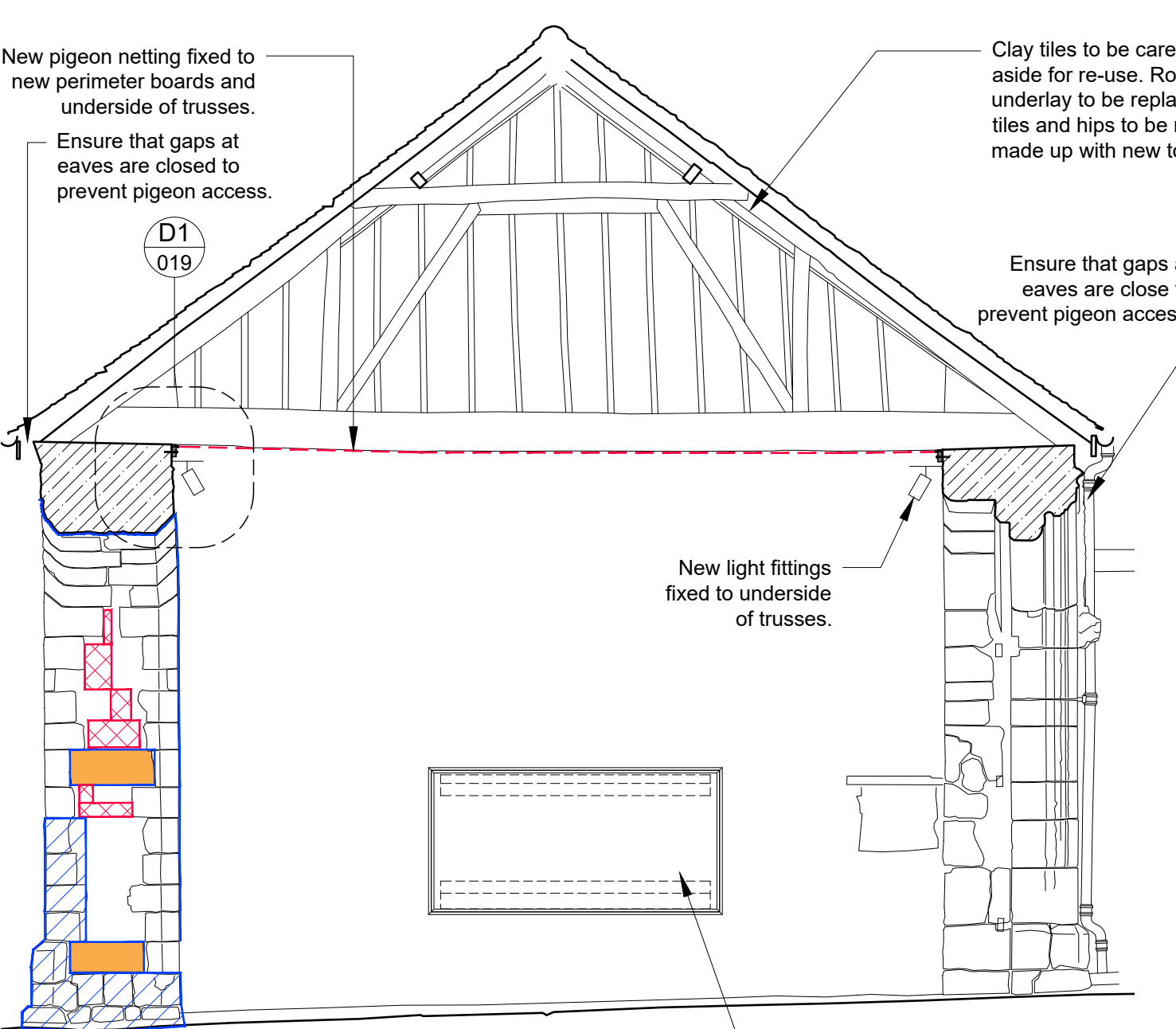

S1- West Section

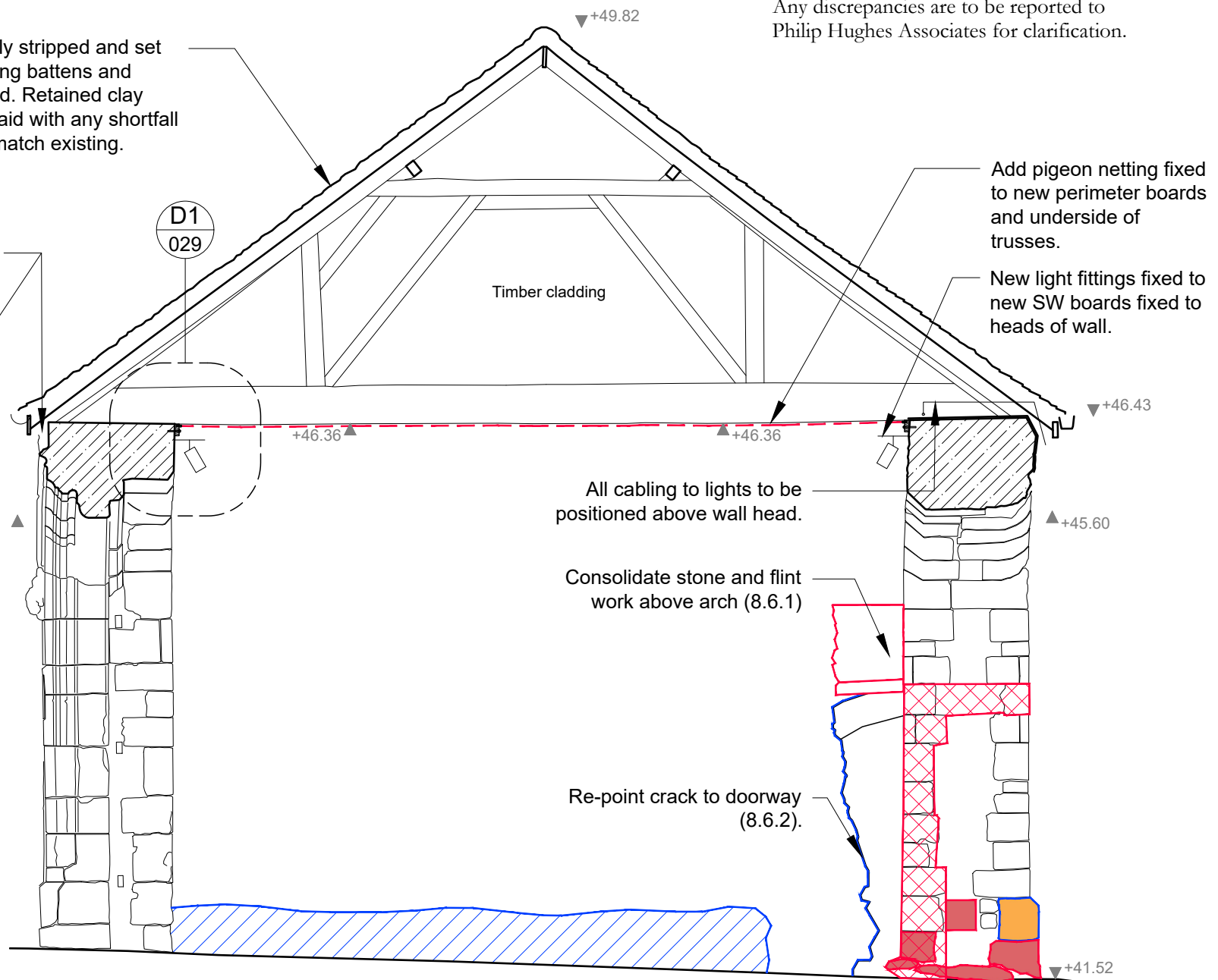

S2- East Section

KEY		
Repair	Reference	Hatch
Mixed Stone and Flint areas- Remove cement and re-point		
Stone or Brick areas- Remove cement and re-point	8.3.2	
Flint and/or Stone areas- re-point	8.6.2, 8.3.3	
Brick re-point		
Shelter coat face of stone	8.3.4	
Mortar repair decayed stone	8.3.6	
Patch re-point		

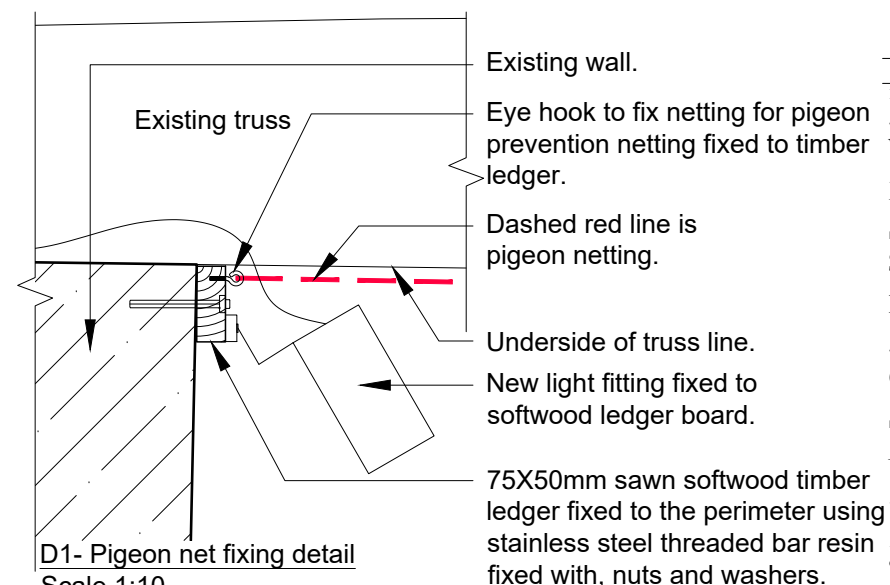
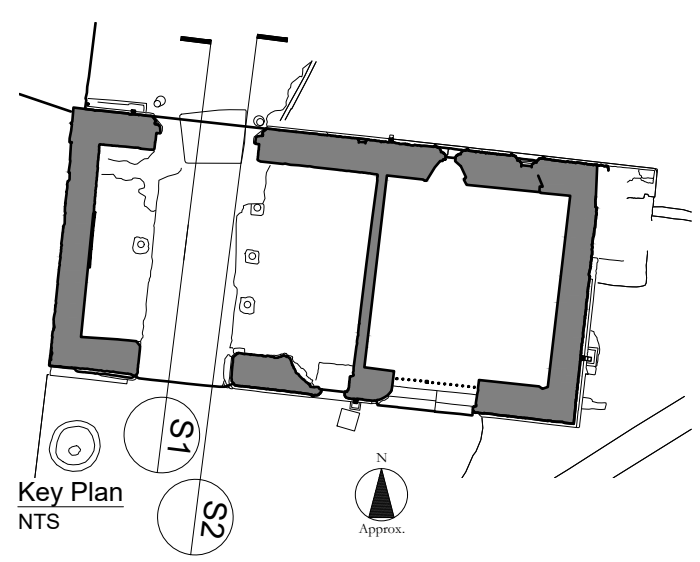

0 1m 2m
 Scale: 1:50

~	04-11-2025	Drawing originated	AT
REV	DATE	NOTES	BY
JOB TITLE			
Winchester			
Hyde Abbey Gateway			
DRAWING TITLE			
Sections S1 & S2			
Repair Works- As Proposed			
JOB No	DWG No	REV	
632/02	029	~	
DRAWN BY	SCALE	DATE	
AT	1:50	NOV 2025	

PHILIP HUGHES ASSOCIATES
 HISTORIC BUILDINGS CONSERVATION CONSULTANTS
 OLD MANOR STABLES TOUT HILL WINCANTON SOMERSET BA9 9DL TEL: 01963 824240 FAX: 01963 824642

NOTES:
 All dimensions are to be checked on site prior to construction.
 Any discrepancies are to be reported to Philip Hughes Associates for clarification.

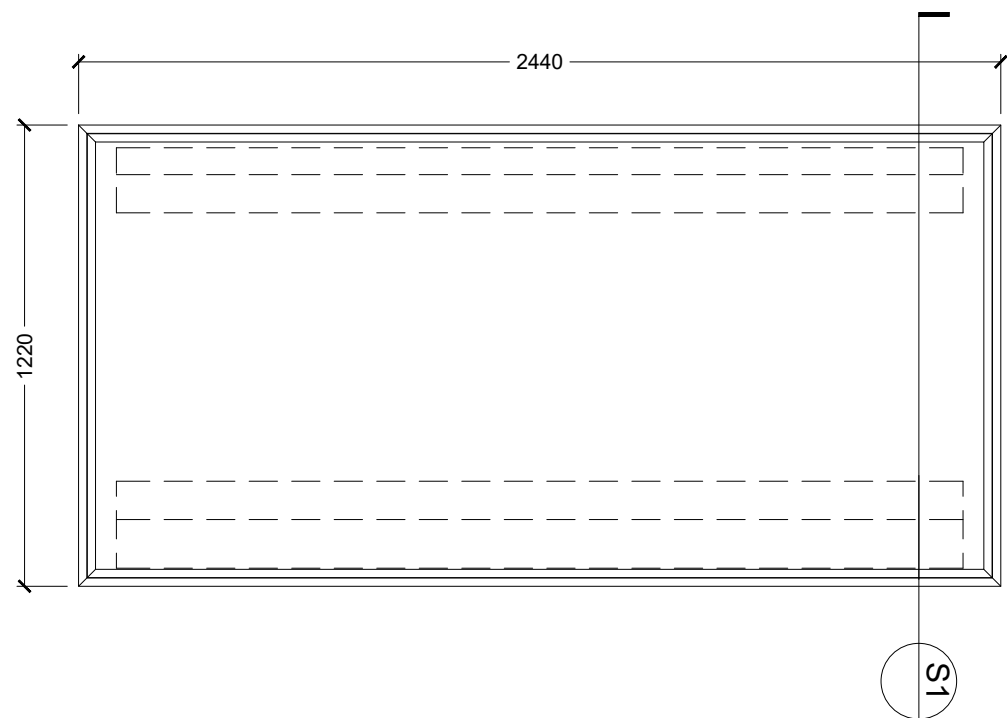

Display Boards- Elevation
 Scale 1:20

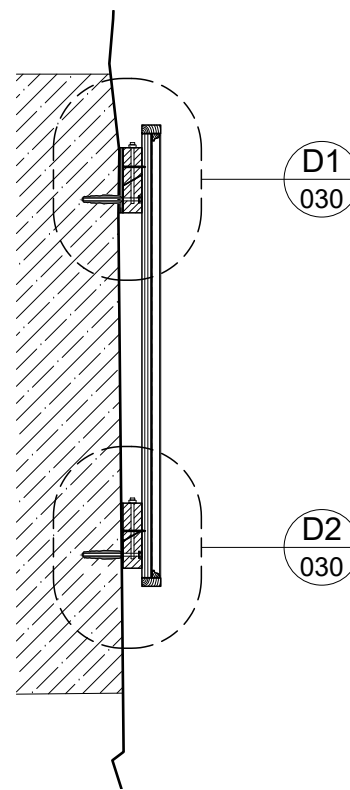

Section S1
 Scale 1:20

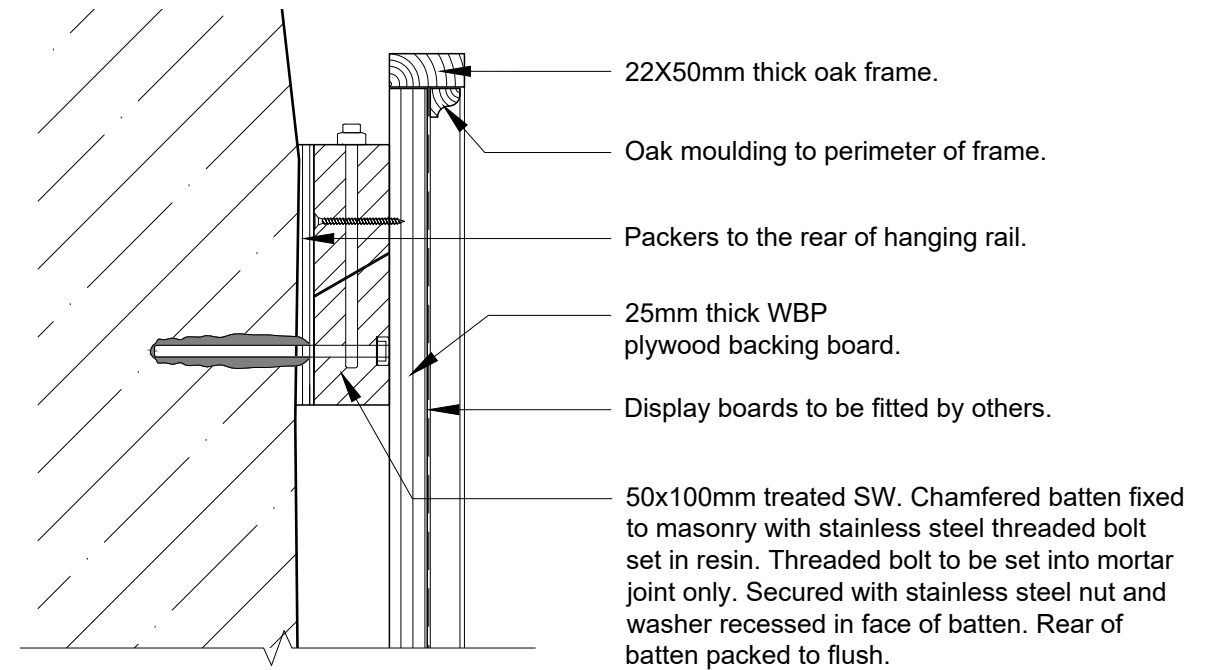

D1- Fixing detail at head
 Scale 1:5

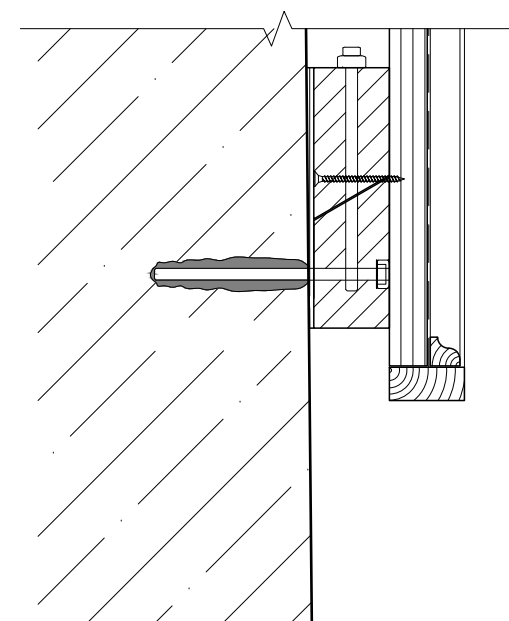

D2- Fixing detail at base
 Scale 1:5

Notes as above.

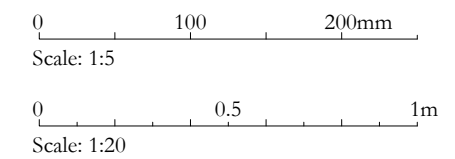

~	28-11-2025	Drawing originated	AT
REV	DATE	NOTES	BY

JOB TITLE
 Winchester
 Hyde Abbey Gateway
 DRAWING TITLE
 Display Board
 Fixing Detail- As Proposed

JOB No	DWG No	REV
632/02	030	~
DRAWN BY	SCALE	DATE
AT	1:20/5 at A3	NOV 2025

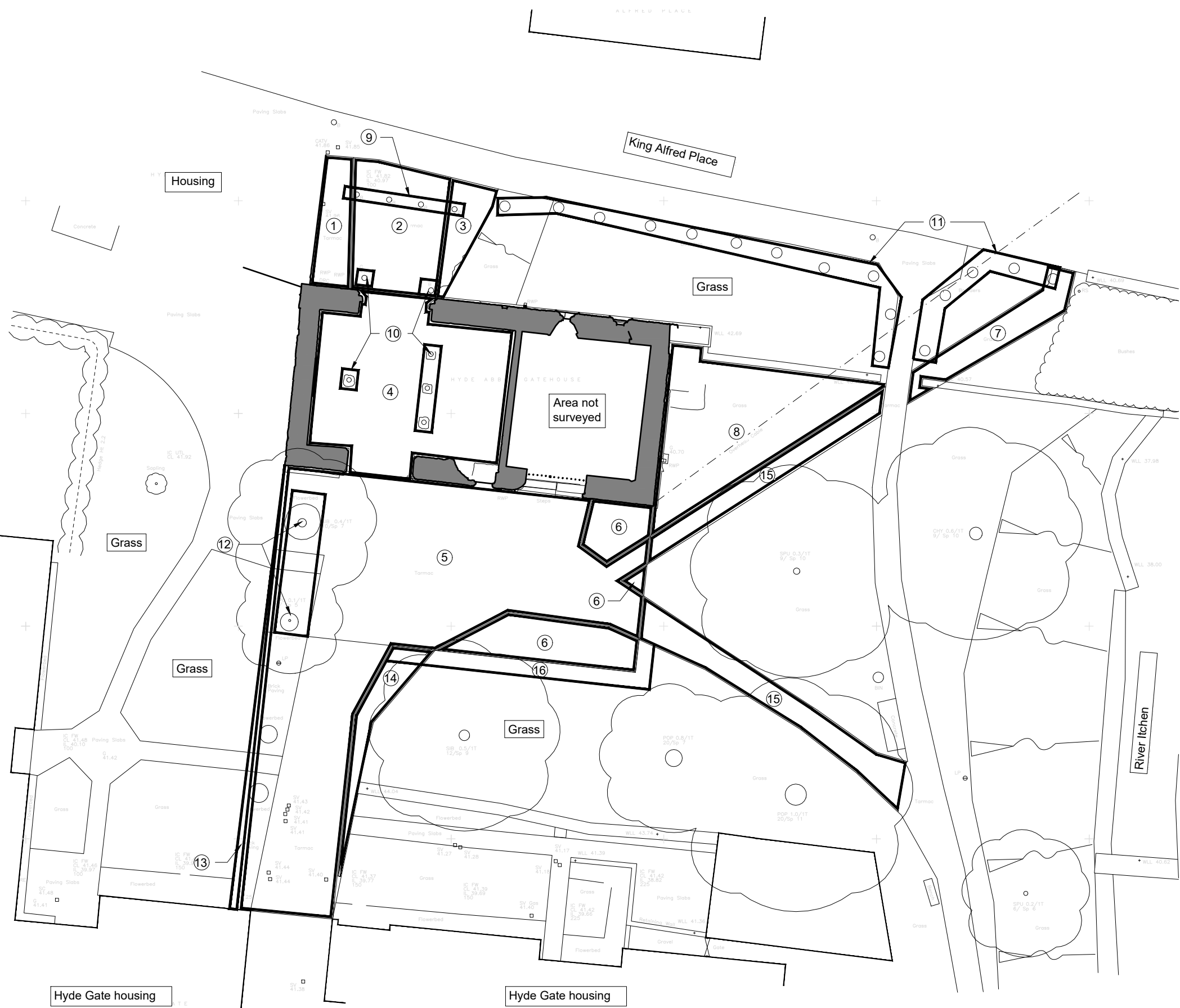

No.	Excavation/ Preparatory work	Landscaping
①	Excavate tarmac	Add 150 mm top soil.
②	Excavate tarmac	New setts to Landscape Architect's specification. (Historic finishes to be retained if found).
③	Excavate tarmac	Add 150 mm top soil.
④	Excavate tarmac	New setts to Landscape Architect's specification. (Historic finishes to be retained if found).
⑤	Excavate tarmac	New resin bound gravel + Granite trims and seating to Landscape Architect's specification.
⑥	Remove grassed area	New resin bound gravel + Granite trims and seating to Landscape Architect's specification.
⑦	Excavate ground	New self binding gravel to Landscape Architect's specification.
⑧	Remove grass/ planting and cultivate.	New planting to Landscape Architect's specification.
⑨	Remove bollards & foundations.	New cubes to Landscape Architect's specification
⑩	Remove bollards & foundations.	New setts to Landscape Architect's specification.
⑪	Relocate existing stones.	
⑫	Remove 2 no. of trees and poison.	
⑬	Excavate paving	Make good lawn edge.
⑭	Excavate tarmac	Make good lawn edge.
⑮	Make good existing tarmac surface.	Overlay existing tarmac path with 20mm wearing course + fit new kerbs.
⑯	Excavate grassed area	Add 450mm top soil.

Note: Refer landscape Architects drawings and specification for detail of landscape finishes and planting.

SITE PLAN
Scale 1:200

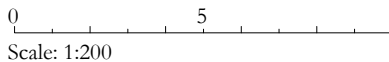

NOTES:
All dimensions are to be checked on site prior to construction.
Any discrepancies are to be reported to Philip Hughes Associates for clarification.

REV	DATE	NOTES	BY
~	27-11-2025	Drawing originated	AT
JOB TITLE			
Winchester			
Hyde Abbey Gateway			
DRAWING TITLE			
Site Plan			
Landscape Excavation/Preparatory Work			
JOB No	DWG No	REV	
632/02	031	~	
DRAWN BY	SCALE	DATE	
AT	1:200	NOV 2025	

