

Riceen and Holmecot, Lockhams Road, Curdridge, Winchester, Hampshire

WINCHESTER CITY COUNCIL
PLANNING DEPARTMENT

"This copy has been made by, [redacted] the authority of the
Chief Planning Officer, pursuant to section 47 of the
Copyright, Design and Patent Act 1988 (the act).

11 JUN 2002

Unless the act provides a relevant exception to copyright,
the copy must not be copied without the prior permission of
the copyright owner.
The council does not accept responsibility for the accuracy
of these plans.

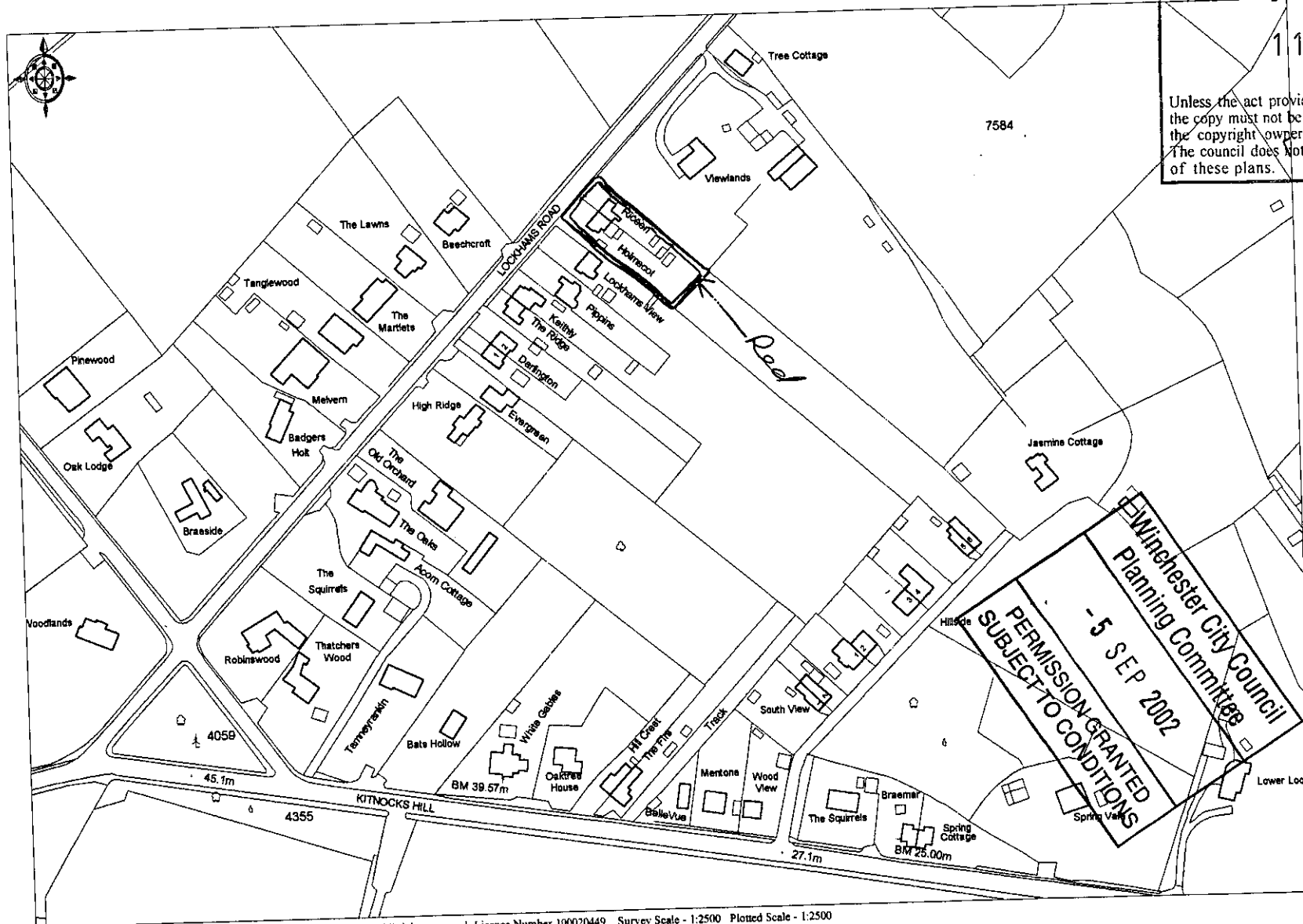

7584

Jasmine Cottage

Hillside

6

© Crown copyright 2002. All rights reserved. Licence Number 100020449. Survey Scale - 1:2500 Plotted Scale - 1:2500



6493/01

Winchester City Council
Planning Committee
- 5 SEP 2002
**PERMISSION GRANTED
SUBJECT TO CONDITIONS**

W17869