



DRAFT PORTFOLIO HOLDER DECISION NOTICE

PROPOSED INDIVIDUAL DECISION BY THE PORTFOLIO HOLDER FOR PLANNING AND TRANSPORT

TOPIC – TRAFFIC REGULATION ORDER – LOWER STANMORE AREA, WINCHESTER

PROCEDURAL INFORMATION

The Access to Information Procedure Rules – Part 4, Section 22 of the Council's Constitution provides for a decision to be made by an individual member of Cabinet.

In accordance with the Procedure Rules, the Corporate Director (Governance), the Chief Executive and the Head of Finance are consulted together with Chairman and Vice Chairman of The Overview and Scrutiny Committee and any other relevant overview and scrutiny committee. In addition, all Members are notified.

If five or more Members from those informed so request, the Leader may require the matter to be referred to Cabinet for determination.

If you wish to make representation on this proposed Decision please contact the relevant Portfolio Holder and the following Committee Administrator by 5.00pm on Thursday 28 June 2012.

Contact Officers:

Case Officer:

Neville Crisp. Traffic Engineer. Tel: 01962 848484. Email: ncrisp@winchester.gov.uk

Committee Administrator:

Nancy Graham. Senior Democratic Services Officer. Tel: 01962 848235.

Email: ngraham@winchester.gov.uk

SUMMARY

- Following consultation with residents of Stanmore a scheme was drawn up to introduce new and revised waiting restrictions in the Lower Stanmore area of Winchester. Copies of the plan showing the location of the proposal (Appendix 1), schedule and statement of reasons (Appendix 2) are attached.
- The proposed changes were advertised on 2nd May 2012. The full notice was published in the Mid Hants Observer, posted on the WCC website together

with a plan, and the full notice and a large scale plan were placed on deposit. Summary notices were posted on site. Copies of these notices are attached. (Appendix 3)

- No objections were received in response to the proposal as advertised.
- The proposal is in keeping with the Corporate Priorities in its attempt to improve traffic management, road safety and the environment and for encouraging inclusive communities.

PROPOSED DECISION

1. It is recommended to introduce restrictions as advertised and detailed in the schedule attached. (Appendix 2)
2. That the Head of Legal Services be authorised to make the necessary order.

REASON FOR THE DECISION AND OTHER ALTERNATIVE OPTIONS CONSIDERED AND REJECTED

- All schemes included within the draft programme and other requests received have been assessed against criteria which include road safety, the concerns of the police, Ward Councillors and the Community.

RESOURCE IMPLICATIONS:

- The cost of implementing the traffic regulation order and any associated signs and lining work is covered by the Traffic Management agreement with Hampshire County Council.
- Enforcement of any new restrictions will be carried out within existing budgets.

CONSULTATION UNDERTAKEN ON THE PROPOSED DECISION

- All residents of Stanmore were informally consulted by letter - the responses showed that only those residents of Lower Stanmore were in favour of new restrictions.
- A scheme was drafted and details sent to all residents of Lower Stanmore for further comment which resulted in minor amendments. The revised scheme was submitted to the local Ward Members, County Councillor, Police and WCC Parking Office Manager for their consent to proceed to formal advertisement.
- The proposed changes were advertised on 2nd May 2012. The full notice was published in the Mid Hants Observer, posted on the WCC website together with a plan, and the full notice and a large scale plan were placed on deposit. Summary notices were posted on site.

**FURTHER ALTERNATIVE OPTIONS CONSIDERED AND REJECTED
FOLLOWING PUBLICATION OF THE DRAFT PORTFOLIO HOLDER DECISION
NOTICE**

n/a

**DECLARATION OF INTERESTS BY THE DECISION MAKER OR A MEMBER OR
OFFICER CONSULTED**

None.

DISPENSATION GRANTED BY THE STANDARDS COMMITTEE

Not applicable.

Approved by: (signature)

Date of Decision

Councillor Victoria Weston – Portfolio Holder for Planning and Transport

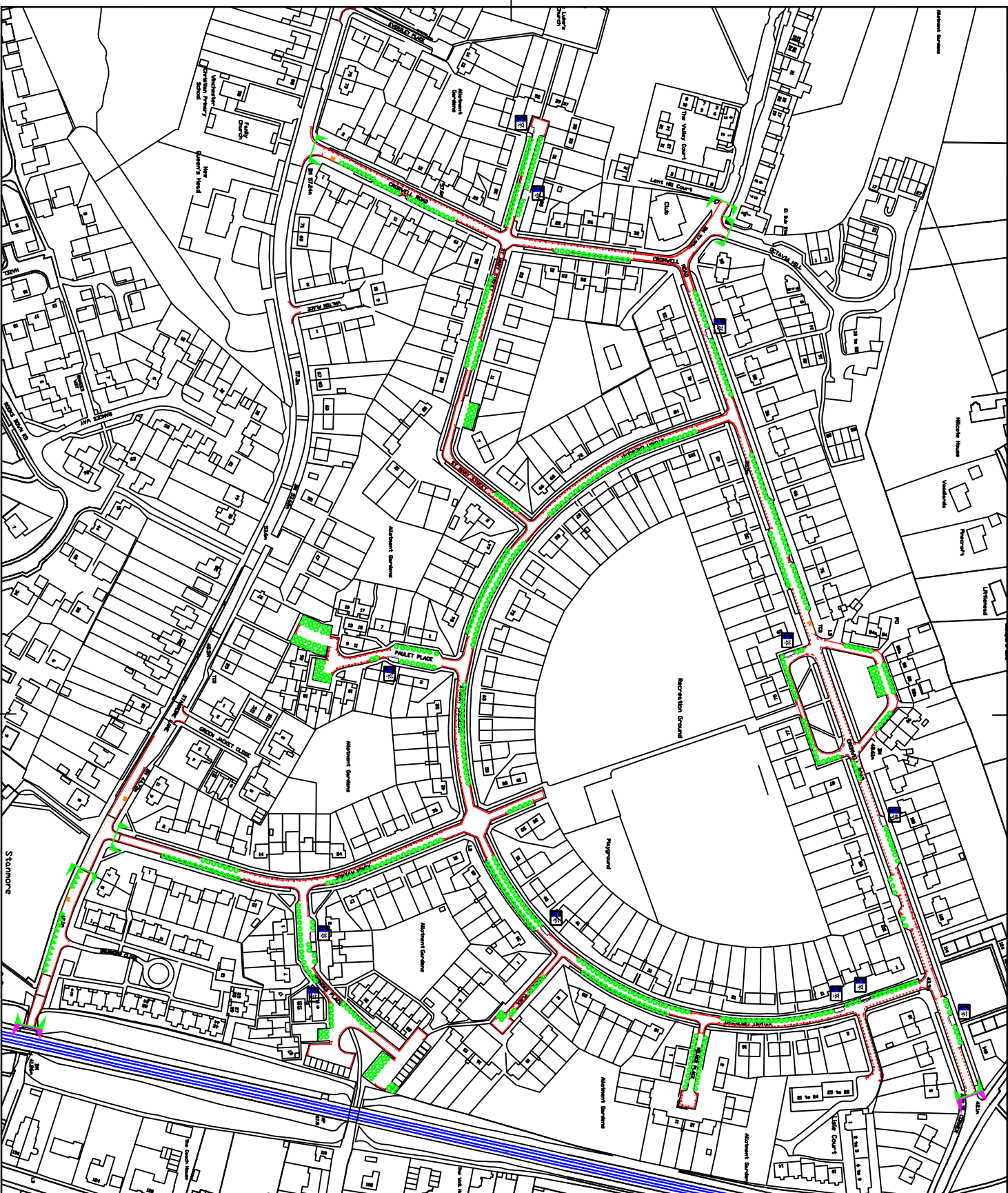

- NO WAITING AT ANY TIME (DOUBLE YELLOW LINES)
- EIGHTH OF WAITING 10MIN TO 15MIN (DOUBLE YELLOW LINES)
- 1 HOUR LIMITED WAITING PERMITTED WITH PERMIT HOLDERS EXCEPT 10:00AM TO 4:00PM MONDAY TO FRIDAY (DOUBLE YELLOW LINES)
- 2 HOUR LIMITED WAITING PERMITTED WITH PERMIT HOLDERS EXCEPT 10:00AM TO 4:00PM MONDAY TO FRIDAY
- 2 HOUR LIMITED WAITING PERMITTED WITH PERMIT HOLDERS EXCEPT 10:00AM TO 4:00PM MONDAY TO FRIDAY
- DISABLED BADGE HOLDERS ONLY
- 10.5 STOPPED BUSES
- START OF EXISTING ONE-WAY TRAFFIC ZONE
- EXISTING ONE-WAY TRAFFIC ZONE

Ref	Description	Date	Drawn
A	Bus locations in Public Place, Priests Place, St Mary Street and Overall Road	08/04/22	NMC

Winchester
City Council

OPERATIONS GROUP
ACCESS & INFRASTRUCTURE

City Offices
Colebrook Street
Winchester,
SO23 9LU.

Project: PERMANENT TRAFFIC REGULATION ORDERS

Title: PROPOSED WAITING RESTRICTIONS LOWER STANNMORE WINCHESTER

Scale: NTS	Date: DEC 2011
Drawn: NVC	Checked:
Disc. No. 810402/226/001 A	Status:

PROPOSED VARIATION TO:-

HAMPSHIRE COUNTY COUNCIL

ROAD TRAFFIC REGULATION ACT 1984

THE HAMPSHIRE (VARIOUS ROADS, WINCHESTER)
(PARKING PLACES AND RESTRICTION OF WAITING)
(NO. 2) ORDER 2002

AND

THE HAMPSHIRE (VARIOUS ROADS, WINCHESTER)
(PARKING PLACES AND RESTRICTION OF WAITING)
(CONTROLLED ZONE) (CONSOLIDATION) ORDER 2010

STATEMENT OF REASONS FOR REVISION:-

On traffic management and road safety grounds to ensure unobstructed access.

EXISTING ITEMS IN CONTROLLED ZONE ORDER TO BE DELETED**SCHEDULE I Pt IV****1 Hour Limited Waiting With Permit Holders Exemption 8:00am to 6:00pm Monday to Saturday**

<u>Road Name</u>	<u>Side</u>	<u>Description</u>	<u>Zone</u>
CROMWELL ROAD	NORTHERN SIDE OF NORTH SERVICE ROAD	BETWEEN A POINT 215.0 METRES WEST OF ITS JUNCTION WITH AIRLIE ROAD AND A POINT 230.0 METRES WEST OF THAT JUNCTION	2A
CROMWELL ROAD	NORTHERN SIDE OF NORTH SERVICE ROAD	BETWEEN A POINT 245.5 METRES WEST OF ITS JUNCTION WITH AIRLIE ROAD AND A POINT 260.0 METRES WEST OF THAT JUNCTION	2A
CROMWELL ROAD	NORTHERN SIDE OF NORTH SERVICE ROAD	BETWEEN A POINT 274.0 METRES WEST OF ITS JUNCTION WITH AIRLIE ROAD AND A POINT 283.0 METRES WEST OF THAT JUNCTION	2A

SCHEDULE I Pt VIII**Echelon Parking 1 Hour Limited Waiting With Permit Holders Exemption 8:00am to 6:00pm Monday to Saturday**

<u>Road Name</u>	<u>Side</u>	<u>Description</u>	<u>Zone</u>
CROMWELL ROAD	SOUTHERN SIDE OF NORTH SERVICE ROAD	BETWEEN A POINT 241.5 METRES WEST OF ITS JUNCTION WITH AIRLIE ROAD AND A POINT 257.0 METRES WEST OF THAT JUNCTION	2A

SCHEDULE II**No Waiting At Any Time**

<u>Road Name</u>	<u>Side</u>	<u>Description</u>	<u>Zone</u>
CROMWELL ROAD	NORTHERN SIDE OF NORTH SERVICE ROAD	BETWEEN A POINT 204.3 METRES WEST OF ITS JUNCTION WITH AIRLIE ROAD AND A POINT 215.0 METRES WEST OF THAT JUNCTION	2A
CROMWELL ROAD	NORTHERN SIDE OF NORTH SERVICE ROAD	BETWEEN A POINT 230.0 METRES WEST OF ITS JUNCTION WITH AIRLIE ROAD AND A POINT 245.5 METRES WEST OF THAT JUNCTION	2A
CROMWELL ROAD	NORTHERN SIDE OF NORTH SERVICE ROAD	BETWEEN A POINT 260.0 METRES WEST OF ITS JUNCTION WITH AIRLIE ROAD AND A POINT 274.0 METRES WEST OF THAT JUNCTION	2A
CROMWELL ROAD	NORTHERN SIDE OF NORTH SERVICE ROAD	BETWEEN A POINT 283.0 METRES WEST OF ITS JUNCTION WITH AIRLIE ROAD AND A POINT 293.5 METRES WEST OF THAT JUNCTION	2A

PHD417 – APPENDIX 2

<u>Road Name</u>	<u>Side ROAD</u>	<u>Description</u>	<u>Zone</u>
CROMWELL ROAD	SOUTHERN SIDE OF NORTH SERVICE ROAD	BETWEEN A POINT 204.3 METRES WEST OF ITS JUNCTION WITH AIRLIE ROAD AND A POINT 241.5 METRES WEST OF THAT JUNCTION	2A
CROMWELL ROAD	SOUTHERN SIDE OF NORTH SERVICE ROAD	BETWEEN A POINT 257.0 METRES WEST OF ITS JUNCTION WITH AIRLIE ROAD AND A POINT 293.5 METRES WEST OF THAT JUNCTION	2A

EXISTING ITEMS IN NO. 2 ORDER TO BE DELETEDSCHEDULE I Pt XVII
Disabled Permit Holders Only

<u>Road Name</u>	<u>Side</u>	<u>Description</u>	<u>Zone</u>
CROMWELL ROAD	SOUTHERN SIDE OF SOUTH SERVICE ROAD	BETWEEN A POINT 296.3 METRES WEST OF ITS JUNCTION WITH AIRLIE ROAD AND A POINT 301.7 METRES WEST OF THAT JUNCTION	*
ST MARY STREET	SOUTH	BETWEEN A POINT 54.0 METRES WEST OF ITS JUNCTION WITH CROMWELL ROAD AND A POINT 59.5 METRES WEST OF THAT JUNCTION.	*
STUART CRESCENT	SOUTH	BETWEEN A POINT 27.0 METRES SOUTH OF ITS EASTERLY JUNCTION WITH CROMWELL ROAD AND A POINT 38.5 METRES SOUTH OF THAT JUNCTION.	*

SCHEDULE II
No Waiting At Any Time

<u>Road Name</u>	<u>Side</u>	<u>Description</u>	<u>Zone</u>
CROMWELL ROAD	BOTH	BETWEEN ITS JUNCTION WITH STANMORE LANE AND A POINT 11.0 METRES NORTH OF THAT JUNCTION	*
CROMWELL ROAD	BOTH	BETWEEN A POINT 20.0 METRES EAST OF ITS JUNCTION WITH THE VALLEY AND A POINT 29.0 METRES SOUTH OF THAT JUNCTION	*
CROMWELL ROAD	BOTH	BETWEEN A POINT 13.5 METRES EAST OF ITS WESTERLY JUNCTION WITH STUART CRESCENT TO A POINT 7.5 METRES WEST OF THAT JUNCTION	*
KINGS AVENUE	EAST	BETWEEN A POINT 15.2 METRES NORTH OF ITS JUNCTION WITH STUART CRESCENT TO A POINT 15.0 METRES SOUTH OF THAT JUNCTION	*
KINGS AVENUE	WEST	BETWEEN A POINT 12.2 METRES NORTH OF ITS JUNCTION WITH STUART CRESCENT TO A POINT 15.0 METRES SOUTH OF THAT JUNCTION	*
KINGS AVENUE	EAST	BETWEEN ITS JUNCTION WITH STANMORE LANE AND A POINT 29.3 METRES NORTH OF THAT JUNCTION	*
KINGS AVENUE	WEST	BETWEEN ITS JUNCTION WITH STANMORE LANE AND A POINT 54.3 METRES NORTH OF THAT JUNCTION	*
STUART CRESCENT	BOTH	BETWEEN ITS WESTERLY JUNCTION WITH CROMWELL ROAD AND A POINT 20.0 METRES SOUTH OF THAT JUNCTION	*
STUART CRESCENT	NORTH	BETWEEN A POINT 22.5 METRES EAST OF ITS JUNCTION WITH KINGS AVENUE AND A POINT 21.0 METRES WEST OF THAT JUNCTION	*
STUART	SOUTH	BETWEEN A POINT 18.0 METRES EAST OF ITS	*

<u>Road Name</u>	<u>Side</u>	<u>Description</u>	<u>Zone</u>
CRESCENT		JUNCTION WITH KINGS AVENUE AND A POINT 24.0 METRES WEST OF THAT JUNCTION	
THE VALLEY	BOTH	BETWEEN ITS JUNCTION WITH CROMWELL ROAD AND A POINT 10.0 METRES NORTH OF THAT JUNCTION	*

SCHEDULE V

No Waiting 8:00am to 6:00pm Monday to Saturday

<u>Road Name</u>	<u>Side</u>	<u>Description</u>	<u>Zone</u>
CROMWELL ROAD	NORTH	BETWEEN A POINT 168.2 METRES WEST OF ITS JUNCTION WITH AIRLIE ROAD AND A POINT 277.9 METRES WEST OF THAT JUNCTION	*
CROMWELL ROAD	SOUTH	BETWEEN A POINT 96.7 METRES EAST OF ITS WESTERLY JUNCTION WITH STUART CRESCENT TO A POINT 137.2 METRES EAST OF THAT JUNCTION	*
CROMWELL ROAD	SOUTH	BETWEEN A POINT 185.0 METRES EAST OF ITS WESTERLY JUNCTION WITH STUART CRESCENT TO A POINT 198.0 METRES EAST OF THAT JUNCTION	*
CROMWELL ROAD	SOUTH	BETWEEN A POINT 7.5 METRES WEST OF ITS WESTERLY JUNCTION WITH STUART CRESCENT TO A POINT 20.0 METRES EAST OF ITS JUNCTION WITH THE VALLEY	*
CROMWELL ROAD	SOUTH	BETWEEN A POINT 13.5 METRES EAST OF ITS WESTERLY JUNCTION WITH STUART CRESCENT TO A POINT 65.0 METRES EAST OF THAT JUNCTION	*
CROMWELL ROAD	SOUTH	BETWEEN A POINT 96.7 METRES EAST OF ITS WESTERLY JUNCTION WITH STUART CRESCENT TO A POINT 198.0 METRES EAST OF THAT JUNCTION	*

SCHEDULE XII

No Waiting 10:00am to 4:00pm Monday to Friday

<u>Road Name</u>	<u>Side</u>	<u>Description</u>	<u>Zone</u>
STUART CRESCENT	BOTH	BETWEEN A POINT 8.0 METRES NORTH OF ITS JUNCTION WITH MILNER PLACE TO A POINT 8.0 METRES SOUTH OF THAT JUNCTION	*
MILNER PLACE	BOTH	BETWEEN ITS JUNCTION WITH STUART CRESCENT TO A POINT 5.3 METRES EAST OF THAT JUNCTION	*
MILNER PLACE	BOTH	BETWEEN A POINT 37.4 METRES EAST OF ITS JUNCTION WITH STUART CRESCENT TO A POINT 47.3 METRES EAST OF THAT JUNCTION INCLUDING THE TURNING HEAD	*

NEW ITEMS FOR NO. 2 ORDERSCHEDULE I Pt XVII
Disabled Permit Holders Only

<u>Road Name</u>	<u>Side</u>	<u>Description</u>	<u>Zone</u>
CROMWELL ROAD	NORTH	BETWEEN A POINT 43.7 METRES WEST OF ITS JUNCTION WITH AIRLIE ROAD AND A POINT 49.2 METRES WEST OF THAT JUNCTION	2A
CROMWELL ROAD	NORTH	BETWEEN A POINT 161.5 METRES WEST OF ITS JUNCTION WITH AIRLIE ROAD AND A POINT 167.8 METRES WEST OF THAT JUNCTION	2A
CROMWELL ROAD	NORTH	BETWEEN A POINT 40.0 METRES EAST OF ITS JUNCTION WITH THE VALLEY AND A POINT 45.5 METRES EAST OF THAT JUNCTION	2A
CROMWELL ROAD – SOUTH SERVICE ROAD	SOUTH-WEST	BETWEEN A POINT 296.3 METRES WEST OF ITS JUNCTION WITH AIRLIE ROAD AND A POINT 301.7 METRES WEST OF THAT JUNCTION	2A
PAULET PLACE - SPINE	EAST	BETWEEN A POINT 32.0 METRES SOUTH OF ITS JUNCTION WITH STUART CRESCENT AND A POINT 38.8 METRES SOUTH OF THAT JUNCTION	2A
PRINCES PLACE - SPINE	NORTH	BETWEEN A POINT 24.4 METRES EAST OF ITS JUNCTION WITH KINGS AVENUE AND A POINT 29.6 METRES EAST OF THAT JUNCTION	2A
PRINCES PLACE - SPINE	SOUTH	BETWEEN A POINT 53.7 METRES EAST OF ITS JUNCTION WITH KINGS AVENUE AND A POINT 59.7 METRES EAST OF THAT JUNCTION	2A
ST MARY STREET	NORTH	BETWEEN A POINT 19.3 METRES WEST OF ITS JUNCTION WITH CROMWELL ROAD AND A POINT 24.9 METRES WEST OF THAT JUNCTION.	2A
ST MARY STREET	SOUTH	BETWEEN A POINT 55.2 METRES WEST OF ITS JUNCTION WITH CROMWELL ROAD AND A POINT 60.0 METRES WEST OF THAT JUNCTION.	2A
STUART CRESCENT	NORTH	BETWEEN A POINT 38.0 METRES SOUTH OF ITS EASTERLY JUNCTION WITH CROMWELL ROAD AND A POINT 43.5 METRES SOUTH OF THAT JUNCTION.	2A
STUART CRESCENT	NORTH	BETWEEN A POINT 51.0 METRES SOUTH OF ITS EASTERLY JUNCTION WITH CROMWELL ROAD AND A POINT 57.8 METRES SOUTH OF THAT JUNCTION.	2A
STUART CRESCENT	NORTH	BETWEEN A POINT 69.2 METRES NORTHEAST OF ITS JUNCTION WITH KINGS AVENUE AND POINT 75.0 METRES NORTHEAST OF THAT JUNCTION	2A

SCHEDULE I Pt XVIII2 Hour Limited Waiting 8:00am to 6:00pm Monday to Saturday

<u>Road Name</u>	<u>Side</u>	<u>Description</u>	<u>Zone</u>
STANMORE LANE	SOUTH	BETWEEN A POINT 20.6 METRES WEST OF ITS JUNCTION WITH KINGS AVENUE AND A POINT 31.7	*

<u>Road Name</u>	<u>Side</u>	<u>Description</u>	<u>Zone</u>
		METRES WEST OF THAT JUNCTION	
STANMORE LANE	SOUTH	BETWEEN A POINT 46.0 METRES WEST OF ITS JUNCTION WITH KINGS AVENUE AND A POINT 75.3 METRES WEST OF THAT JUNCTION	*

SCHEDULE II
No Waiting At Any Time

<u>Road Name</u>	<u>Side</u>	<u>Description</u>	<u>Zone</u>
CROMWELL ROAD	BOTH	BETWEEN ITS JUNCTION WITH STANMORE LANE AND A POINT 11.0 METRES NORTH OF THAT JUNCTION	2A
CROMWELL ROAD	WEST	BETWEEN A POINT 8.7 METRES SOUTH OF ITS JUNCTION WITH ST MARY STREET AND A POINT 7.0 METRES NORTH OF THAT JUNCTION	2A
CROMWELL ROAD	WEST	BETWEEN A POINT 29.0 METRES SOUTH OF ITS JUNCTION WITH THE VALLEY AND A POINT 10.4 METRES EAST OF THAT JUNCTION	2A
CROMWELL ROAD	NORTH	BETWEEN A POINT 66.7 METRES EAST OF ITS JUNCTION WITH THE VALLEY TO A POINT 110.7 METRES EAST OF THAT JUNCTION	2A
CROMWELL ROAD	NORTH	BETWEEN A POINT 164.6 METRES EAST OF ITS JUNCTION WITH THE VALLEY AND A POINT 171.6 METRES EAST OF THAT JUNCTION	2A
CROMWELL ROAD	NORTH	BETWEEN A POINT 93.6 METRES WEST OF ITS JUNCTION WITH AIRLIE ROAD AND A POINT 62.2 METRES WEST OF THAT JUNCTION	2A
CROMWELL ROAD	EAST	BETWEEN A POINT 57.7 METRES NORTH OF ITS JUNCTION WITH STANMORE LANE AND A POINT 61.4 METRES NORTH OF THAT JUNCTION	2A
CROMWELL ROAD	EAST	BETWEEN A POINT 8.7 METRES SOUTH OF ITS JUNCTION WITH ST MARY STREET AND A POINT 8.0 METRES NORTH OF THAT JUNCTION	2A
CROMWELL ROAD	EAST	BETWEEN A POINT 65.0 METRES NORTH OF ITS JUNCTION WITH ST MARY STREET AND A POINT 64.6 METRES WEST OF ITS WESTERLY JUNCTION WITH STUART CRESCENT	2A
CROMWELL ROAD	SOUTH	BETWEEN A POINT 15.7 METRES WEST OF ITS WESTERLY JUNCTION WITH STUART CRESCENT TO A POINT 11.0 METRES EAST OF THAT JUNCTION	2A
CROMWELL ROAD	SOUTH	BETWEEN A POINT 10.0 METRES WEST OF ITS EASTERLY JUNCTION WITH STUART CRESCENT AND A POINT 62.2 METRES WEST OF ITS JUNCTION WITH AIRLIE ROAD	2A
CROMWELL ROAD – NORTH SERVICE ROAD	NORTH-EAST	BETWEEN A POINT 204.3 METRES WEST OF ITS JUNCTION WITH AIRLIE ROAD AND A POINT 215.0 METRES WEST OF THAT JUNCTION	2A

PHD417 – APPENDIX 2

<u>Road Name</u>	<u>Side</u>	<u>Description</u>	<u>Zone</u>
CROMWELL ROAD – NORTH SERVICE ROAD	NORTH- EAST	BETWEEN A POINT 230.0 METRES WEST OF ITS JUNCTION WITH AIRLIE ROAD AND A POINT 245.5 METRES WEST OF THAT JUNCTION	2A
CROMWELL ROAD – NORTH SERVICE ROAD	NORTH- WEST	BETWEEN A POINT 260.0 METRES WEST OF ITS JUNCTION WITH AIRLIE ROAD AND A POINT 274.0 METRES WEST OF THAT JUNCTION	2A
CROMWELL ROAD – NORTH SERVICE ROAD	NORTH- WEST	BETWEEN A POINT 283.0 METRES WEST OF ITS JUNCTION WITH AIRLIE ROAD AND A POINT 293.5 METRES WEST OF THAT JUNCTION	2A
CROMWELL ROAD – NORTH SERVICE ROAD	SOUTH- EAST	BETWEEN A POINT 204.3 METRES WEST OF ITS JUNCTION WITH AIRLIE ROAD AND A POINT 241.5 METRES WEST OF THAT JUNCTION	2A
CROMWELL ROAD – NORTH SERVICE ROAD	SOUTH- WEST	BETWEEN A POINT 257.0 METRES WEST OF ITS JUNCTION WITH AIRLIE ROAD AND A POINT 293.5 METRES WEST OF THAT JUNCTION	2A
CROMWELL ROAD – SOUTH SERVICE ROAD	NORTH	BETWEEN A POINT 209.3 METRES WEST OF ITS JUNCTION WITH AIRLIE ROAD AND A POINT 306.7 METRES WEST OF THAT JUNCTION	2A
CROMWELL ROAD – SOUTH SERVICE ROAD	SOUTH	BETWEEN A POINT 251.5 METRES WEST OF ITS JUNCTION WITH AIRLIE ROAD AND A POINT 259.6 METRES WEST OF THAT JUNCTION	2A
KINGS AVENUE	EAST	BETWEEN A POINT 15.2 METRES NORTH OF ITS JUNCTION WITH STUART CRESCENT TO A POINT 16.0 METRES SOUTH OF THAT JUNCTION	2A
KINGS AVENUE	EAST	BETWEEN A POINT 30.0 METRES NORTH OF ITS JUNCTION WITH STUART CRESCENT AND A POINT 38.5 METRES NORTH OF THAT JUNCTION INCLUDING THE TURNING AREA	2A
KINGS AVENUE	EAST	BETWEEN ITS JUNCTION WITH STANMORE LANE AND A POINT 30.4 METRES NORTH OF THAT JUNCTION	2A
KINGS AVENUE	EAST	BETWEEN A POINT 9.0 METRES NORTH OF ITS JUNCTION WITH PRINCES PLACE AND A POINT 13.7 METRES SOUTH OF THAT JUNCTION	2A
KINGS AVENUE	WEST	BETWEEN A POINT 38.5 METRES NORTH OF ITS JUNCTION WITH STUART CRESCENT TO A POINT 16.0 METRES SOUTH OF THAT JUNCTION INCLUDING THE TURNING AREA	2A
KINGS AVENUE	WEST	BETWEEN ITS JUNCTION WITH STANMORE LANE AND A POINT 55.0 METRES NORTH OF THAT JUNCTION	2A
KINGSLEY PLACE	BOTH	BETWEEN ITS JUNCTION WITH STUART CRESCENT TO A POINT 15.0 METRES SOUTHEAST OF THAT JUNCTION	2A
KINGSLEY PLACE	NORTH- EAST	BETWEEN A POINT 27.0 METRES SOUTHEAST OF ITS JUNCTION WITH STUART CRESCENT TO A POINT 38.5 METRES SOUTHEAST OF THAT JUNCTION	2A
KINGSLEY PLACE	NORTH- EAST	BETWEEN A POINT 45.0 METRES SOUTHEAST OF ITS JUNCTION WITH STUART CRESCENT TO A POINT 55.5 METRES SOUTHEAST OF THAT	2A

PHD417 – APPENDIX 2

<u>Road Name</u>	<u>Side</u>	<u>Description</u>	<u>Zone</u>
		JUNCTION INCLUDING THE TURNING AREA	
KINGSLEY PLACE	SOUTH-WEST	BETWEEN A POINT 50.0 METRES SOUTHEAST OF ITS JUNCTION WITH STUART CRESCENT TO A POINT 55.5 METRES SOUTHEAST OF THAT JUNCTION INCLUDING THE TURNING AREA	2A
MILNER PLACE	BOTH	BETWEEN ITS JUNCTION WITH STUART CRESCENT TO A POINT 5.3 METRES EAST OF THAT JUNCTION	2A
OCTAVIA HILL	BOTH	BETWEEN ITS JUNCTION WITH THE VALLEY AND A POINT 7.7 METRES NORTH OF THAT JUNCTION	2A
PAULET PLACE - SPINE	BOTH	BETWEEN ITS JUNCTION WITH STUART CRESCENT TO A POINT 11.8 METRES SOUTH OF THAT JUNCTION	2A
PAULET PLACE – SOUTHERN PARKING AREA	SOUTH	ADJACENT TO REAR ACCESS OF 39 STANMORE LANE FOR A DISTANCE OF 5.0 METRES	2A
PRINCES PLACE - SPINE	NORTH	BETWEEN ITS JUNCTION WITH KINGS AVENUE AND A POINT 15.7 METRES EAST OF THAT JUNCTION	2A
PRINCES PLACE – SPINE	NORTH	BETWEEN A POINT 42.8 METRES EAST OF ITS JUNCTION WITH KINGS AVENUE AND A POINT 63.3 METRES NORTHEAST OF THAT JUNCTION	2A
PRINCES PLACE - SPINE	NORTH	BETWEEN A POINT 92.0 METRES NORTHEAST OF ITS JUNCTION WITH KINGS AVENUE AND A POINT 126.0 METRES NORTHEAST OF THAT JUNCTION	2A
PRINCES PLACE - SPINE	SOUTH	BETWEEN ITS JUNCTION WITH KINGS AVENUE AND A POINT 6.5 METRES EAST OF THAT JUNCTION	2A
PRINCES PLACE - SPINE	SOUTH	BETWEEN A POINT 59.7 METRES NORTHEAST OF ITS JUNCTION WITH KINGS AVENUE AND A POINT 66.7 METRES NORTHEAST OF THAT JUNCTION	2A
PRINCES PLACE - SPINE	SOUTH-EAST	BETWEEN A POINT 88.0 METRES NORTHEAST OF ITS JUNCTION WITH KINGS AVENUE AND A POINT 104.0 METRES NORTHEAST OF THAT JUNCTION	2A
PRINCES PLACE - SPUR	NORTH	BETWEEN A POINT 88.0 METRES NORTHEAST OF ITS JUNCTION WITH KINGS AVENUE AND A POINT 108.5 METRES NORTHEAST OF THAT JUNCTION	2A
PRINCES PLACE – NORTHERN PARKING/GARAGE AREA	EAST	BETWEEN A POINT 123.0 METRES NORTHEAST OF ITS JUNCTION WITH KINGS AVENUE AND A POINT 132.0 METRES NORTHEAST OF THAT JUNCTION (A DISTANCE OF 9.0 METRES)	2A
PRINCES PLACE – NORTHERN PARKING/GARAGE AREA	SOUTH-WEST	BETWEEN A POINT 104.0 METRES NORTHEAST OF ITS JUNCTION WITH KINGS AVENUE AND A POINT 126.0 METRES NORTHEAST OF THAT JUNCTION	2A
PRINCES PLACE – EASTERN PARKING/GARAGE AREA	NORTH	BETWEEN A POINT 108.0 METRES NORTHEAST OF ITS JUNCTION WITH KINGS AVENUE AND A POINT 128.5 METRES NORTHEAST OF THAT JUNCTION	2A
PRINCES PLACE –	SOUTH	BETWEEN A POINT 88.0 METRES NORTHEAST OF	2A

PHD417 – APPENDIX 2

<u>Road Name</u>	<u>Side</u>	<u>Description</u>	<u>Zone</u>
EASTERN PARKING/GARAGE AREA		ITS JUNCTION WITH KINGS AVENUE AND A POINT 106.0 METRES NORTHEAST OF THAT JUNCTION	
ST MARY STREET	BOTH	BETWEEN ITS JUNCTION WITH STUART CRESCENT AND POINT 8.5 METRES SOUTHWEST OF THAT JUNCTION	2A
ST MARY STREET	NORTH	BETWEEN A POINT 12.7 METRES WEST OF ITS JUNCTION WITH CROMWELL ROAD AND A POINT 19.2 EAST OF THAT JUNCTION	2A
ST MARY STREET	NORTH	BETWEEN A POINT 55.2 METRES WEST OF ITS JUNCTION WITH CROMWELL ROAD AND A POINT 66.7 METRES WEST OF THAT JUNCTION INCLUDING THE TURNING AREA	2A
ST MARY STREET	NORTH	BETWEEN A POINT 72.5 METRES EAST OF ITS JUNCTION WITH CROMWELL ROAD AND A POINT 90.5 METRES EAST OF THAT JUNCTION	2A
ST MARY STREET	NORTH	BETWEEN A POINT 104.5 METRES EAST OF ITS JUNCTION WITH CROMWELL ROAD AND A POINT 49.0 METRES SOUTHWEST OF ITS JUNCTION WITH STUART CRESCENT	2A
ST MARY STREET	SOUTH	BETWEEN A POINT 5.3 METRES WEST OF ITS JUNCTION WITH CROMWELL ROAD AND A POINT 19.2 EAST OF THAT JUNCTION	2A
ST MARY STREET	SOUTH	BETWEEN A POINT 29.3 METRES WEST OF ITS JUNCTION WITH CROMWELL ROAD AND A POINT 33.3 METRES WEST OF THAT JUNCTION	2A
ST MARY STREET	SOUTH	BETWEEN A POINT 60.0 METRES WEST OF ITS JUNCTION WITH CROMWELL ROAD AND A POINT 66.7 METRES WEST OF THAT JUNCTION INCLUDING THE TURNING AREA	2A
ST MARY STREET	SOUTH	BETWEEN A POINT 73.0 METRES EAST OF ITS JUNCTION WITH CROMWELL ROAD AND A POINT 49.0 METRES SOUTHWEST OF ITS JUNCTION WITH STUART CRESCENT	2A
STANMORE LANE	NORTH	BETWEEN ITS JUNCTION WITH KINGS AVENUE AND A POINT 100.0 METRES EAST OF THAT JUNCTION	*
STANMORE LANE	SOUTH	BETWEEN A POINT 75.3 METRES EAST OF ITS JUNCTION WITH KINGS AVENUE AND A POINT 100.0 METRES EAST OF THAT JUNCTION	*
STUART CRESCENT	BOTH	BETWEEN ITS WESTERLY JUNCTION WITH CROMWELL ROAD AND A POINT 27.0 METRES SOUTH OF THAT JUNCTION	2A
STUART CRESCENT	BOTH	BETWEEN ITS EASTERLY JUNCTION WITH CROMWELL ROAD AND A POINT 10.0 METRES SOUTH OF THAT JUNCTION	2A
STUART CRESCENT	NORTH	BETWEEN A POINT 183.0 METRES WEST OF ITS JUNCTION WITH KINGS AVENUE AND A POINT 151.5 METRES WEST OF THAT JUNCTION	2A
STUART CRESCENT	NORTH	BETWEEN A POINT 98.0 METRES WEST OF ITS JUNCTION WITH KINGS AVENUE AND A POINT 68.0	2A

<u>Road Name</u>	<u>Side</u>	<u>Description</u>	<u>Zone</u>
		METRES WEST OF THAT JUNCTION	
STUART CRESCENT	NORTH	BETWEEN A POINT 15.0 METRES WEST OF ITS JUNCTION WITH KINGS AVENUE AND A POINT 21.0 METRES EAST OF THAT JUNCTION	2A
STUART CRESCENT	NORTH	BETWEEN A POINT 75.0 METRES NORTHEAST OF ITS JUNCTION WITH KINGS AVENUE AND A POINT 93.9 METRES NORTHEAST OF THAT JUNCTION	2A
STUART CRESCENT	NORTH	BETWEEN A POINT 141.0 METRES NORTHEAST OF ITS JUNCTION WITH KINGS AVENUE AND A POINT 159.0 METRES NORTHEAST OF THAT JUNCTION	2A
STUART CRESCENT	SOUTH	BETWEEN A POINT 10.8 METRES NORTHWEST OF ITS JUNCTION WITH ST MARY STREET AND A POINT 15.3 METRES SOUTHEAST OF THAT JUNCTION	2A
STUART CRESCENT	SOUTH	BETWEEN A POINT 15.5 METRES WEST OF ITS JUNCTION WITH PAULET PLACE AND A POINT 15.5 METRES EAST OF THAT JUNCTION	2A
STUART CRESCENT	SOUTH	BETWEEN A POINT 15.0 METRES WEST OF ITS JUNCTION WITH KINGS AVENUE AND A POINT 16.0 METRES EAST OF THAT JUNCTION	2A
STUART CRESCENT	SOUTH	BETWEEN A POINT 15.5 METRES SOUTHWEST OF ITS JUNCTION WITH KINGSLEY PLACE AND A POINT 15.5 METRES NORTHEAST OF THAT JUNCTION	2A
STUART CRESCENT	SOUTH	BETWEEN A POINT 16.5 METRES SOUTH OF ITS JUNCTION WITH MILNER PLACE AND A POINT 8.0 METRES NORTH OF THAT JUNCTION	2A
THE VALLEY	BOTH	BETWEEN ITS JUNCTION WITH CROMWELL ROAD AND A POINT 40.0 METRES NORTHWEST OF THAT JUNCTION	2A

SCHEDULE XNo Stopping 7:00am to 7:00pm Except Buses

<u>Road Name</u>	<u>Side</u>	<u>Description</u>	<u>Zone</u>
CROMWELL ROAD	NORTH	BETWEEN A POINT 199.0 METRES EAST OF ITS JUNCTION WITH THE VALLEY AND A POINT 208.0 METRES EAST OF THAT JUNCTION	2A
CROMWELL ROAD	SOUTH	BETWEEN A POINT 11.0 METRES NORTH OF ITS JUNCTION WITH STANMORE LANE AND A POINT 23.8 METRES NORTH OF THAT JUNCTION	2A
STANMORE LANE	SOUTH	BETWEEN A POINT 31.7 METRES EAST OF ITS JUNCTION WITH KINGS AVENUE AND A POINT 46.0 METRES EAST OF THAT JUNCTION	2A

SCHEDULE XIINo Waiting 10:00am to 4:00pm Monday to Friday

<u>Road Name</u>	<u>Side</u>	<u>Description</u>	<u>Zone</u>
CROMWELL ROAD	NORTH	BETWEEN ITS JUNCTION WITH AIRLIE ROAD AND	2A

PHD417 – APPENDIX 2

<u>Road Name</u>	<u>Side</u>	<u>Description</u>	<u>Zone</u>
		A POINT 35.0 METRES WEST OF THAT JUNCTION	
CROMWELL ROAD	NORTH	BETWEEN A POINT 93.6 METRES WEST OF ITS JUNCTION WITH AIRLIE ROAD AND A POINT 138.0 METRES WEST OF THAT JUNCTION	2A
CROMWELL ROAD	NORTH	BETWEEN A POINT 167.8 METRES WEST OF ITS JUNCTION WITH AIRLIE ROAD AND A POINT 277.9 METRES WEST OF THAT JUNCTION	2A
CROMWELL ROAD	WEST	BETWEEN A POINT 29.0 METRES SOUTH OF ITS JUNCTION WITH THE VALLEY AND A POINT 7.0 METRES NORTH OF ITS JUNCTION WITH ST MARY STREET	2A
CROMWELL ROAD	WEST	BETWEEN A POINT 8.7 METRES SOUTH OF ITS JUNCTION WITH ST MARY STREET AND A POINT 11.0 METRES NORTH OF ITS JUNCTION WITH STANMORE LANE	2A
CROMWELL ROAD	SOUTH	BETWEEN ITS JUNCTION WITH AIRLIE ROAD AND A POINT 62.2 METRES WEST OF THAT JUNCTION	2A
CROMWELL ROAD	SOUTH	BETWEEN A POINT 10.0 METRES WEST OF ITS EASTERLY JUNCTION WITH STUART CRESCENT AND A POINT 27.6 METRES WEST OF THAT JUNCTION	2A
CROMWELL ROAD	SOUTH	BETWEEN A POINT 38.0 METRES WEST OF ITS EASTERLY JUNCTION WITH STUART CRESCENT AND A POINT 49.1 METRES WEST OF THAT JUNCTION	2A
CROMWELL ROAD	SOUTH	BETWEEN A POINT 57.5 METRES WEST OF ITS EASTERLY JUNCTION WITH STUART CRESCENT AND A POINT 107.0 METRES WEST OF THAT JUNCTION	2A
CROMWELL ROAD	SOUTH	BETWEEN A POINT 96.7 METRES EAST OF ITS WESTERLY JUNCTION WITH STUART CRESCENT TO A POINT 125.0 METRES WEST OF ITS EASTERLY JUNCTION WITH STUART CRESCENT	2A
CROMWELL ROAD	SOUTH	BETWEEN A POINT 11.0 METRES EAST OF ITS WESTERLY JUNCTION WITH STUART CRESCENT TO A POINT 65.0 METRES EAST OF THAT JUNCTION	2A
CROMWELL ROAD	SOUTH	BETWEEN A POINT 15.7 METRES WEST OF ITS WESTERLY JUNCTION WITH STUART CRESCENT TO A POINT 64.6 METRES WEST OF THAT JUNCTION	2A
CROMWELL ROAD	EAST	BETWEEN A POINT 25.0 METRES NORTH OF ITS JUNCTION WITH ST MARY STREET AND A POINT 8.0 METRES NORTH OF THAT JUNCTION	2A
CROMWELL ROAD	EAST	BETWEEN A POINT 8.7 METRES SOUTH OF ITS JUNCTION WITH ST MARY STREET AND A POINT 28.7 METRES SOUTH OF THAT JUNCTION	2A
KINGS AVENUE	EAST	BETWEEN A POINT 13.7 METRES SOUTH OF ITS JUNCTION WITH PRINCES PLACE AND A POINT 76.0 METRES NORTH OF ITS JUNCTION WITH STANMORE LANE	2A

PHD417 – APPENDIX 2

<u>Road Name</u>	<u>Side</u>	<u>Description</u>	<u>Zone</u>
KINGS AVENUE	WEST	BETWEEN A POINT 16.0 METRES SOUTH OF ITS JUNCTION WITH STUART CRESCENT AND A POINT 74.0 METRES NORTH OF ITS JUNCTION WITH STANMORE LANE	2A
KINGSLEY PLACE	SOUTH-WEST	BETWEEN A POINT 15.0 METRES SOUTHEAST OF ITS JUNCTION WITH STUART CRESCENT AND A POINT 45.0 METRES SOUTHEAST OF THAT JUNCTION	2A
LISLE COURT	BOTH	BETWEEN ITS JUNCTION WITH STUART CRESCENT AND A POINT 38.5 METRES EAST OF THAT JUNCTION	2A
MILNER PLACE	BOTH	BETWEEN A POINT 37.4 METRES EAST OF ITS JUNCTION WITH STUART CRESCENT TO A POINT 47.3 METRES EAST OF THAT JUNCTION INCLUDING THE TURNING AREA	2A
PAULET PLACE – SPINE	EAST	BETWEEN A POINT 38.8 METRES SOUTH OF ITS JUNCTION WITH STUART CRESCENT AND A POINT 44.5 METRES SOUTH OF THAT JUNCTION	2A
PAULET PLACE – SPINE	EAST	BETWEEN A POINT 50.8 METRES SOUTH OF ITS JUNCTION WITH STUART CRESCENT AND A POINT 72.2 METRES SOUTH OF THAT JUNCTION	2A
PAULET PLACE - SPINE	WEST	BETWEEN A POINT 38.8 METRES SOUTH OF ITS JUNCTION WITH STUART CRESCENT AND A POINT 70.0 METRES SOUTH OF THAT JUNCTION	2A
PAULET PLACE – SPUR	NORTH	BETWEEN A POINT 70.0 METRES SOUTH OF ITS JUNCTION WITH STUART CRESCENT AND A POINT 82.3 METRES SOUTH OF THAT JUNCTION	2A
PAULET PLACE - SPUR	SOUTH	BETWEEN A POINT 70.0 METRES SOUTH OF ITS JUNCTION WITH STUART CRESCENT AND A POINT 77.0 METRES SOUTH OF THAT JUNCTION	2A
ST MARY STREET	NORTH	BETWEEN A POINT 19.2 METRES SOUTHEAST OF ITS JUNCTION WITH CROMWELL ROAD AND A POINT 55.0 METRES SOUTHEAST OF THAT JUNCTION	2A
ST MARY STREET	NORTH	BETWEEN A POINT 49.0 METRES SOUTHWEST OF ITS JUNCTION WITH STUART CRESCENT AND A POINT 25.5 METRES SOUTHWEST OF THAT JUNCTION	2A
ST MARY STREET	SOUTH	BETWEEN A POINT 49.0 METRES SOUTHWEST OF ITS JUNCTION WITH STUART CRESCENT AND A POINT 8.5 METRES SOUTHWEST OF THAT JUNCTION	2A
STUART CRESCENT	SOUTH	BETWEEN A POINT 10.0 METRES SOUTH OF ITS EASTERLY JUNCTION WITH CROMWELL ROAD TO A POINT 8.0 METRES NORTH OF ITS JUNCTION WITH MILNER PLACE	2A
STUART CRESCENT	SOUTH	BETWEEN A POINT 15.0 METRES WEST OF ITS JUNCTION WITH KINGS AVENUE TO A POINT 11.8 METRES EAST OF ITS JUNCTION WITH PAULET PLACE	2A
STUART	SOUTH	BETWEEN A POINT 10.8 METRES NORTH OF ITS	2A

<u>Road Name</u>	<u>Side</u>	<u>Description</u>	<u>Zone</u>
CRESCENT		JUNCTION WITH ST MARY STREET TO A POINT 27.0 METRES SOUTH OF ITS WESTERLY JUNCTION WITH CROMWELL ROAD	

NEW SCHEDULE

2 Hour Limited Waiting With Permit Holders Exemption 8:00am to 6:00pm Monday to Saturday

<u>Road Name</u>	<u>Side</u>	<u>Description</u>	<u>Zone</u>
CROMWELL ROAD – NORTH SERVICE ROAD	NORTH-EAST	BETWEEN A POINT 215.0 METRES WEST OF ITS JUNCTION WITH AIRLIE ROAD AND A POINT 230.0 METRES WEST OF THAT JUNCTION	2A
CROMWELL ROAD – NORTH SERVICE ROAD	NORTH	BETWEEN A POINT 245.5 METRES WEST OF ITS JUNCTION WITH AIRLIE ROAD AND A POINT 260.0 METRES WEST OF THAT JUNCTION	2A
CROMWELL ROAD – NORTH SERVICE ROAD	NORTH-WEST	BETWEEN A POINT 274.0 METRES WEST OF ITS JUNCTION WITH AIRLIE ROAD AND A POINT 283.0 METRES WEST OF THAT JUNCTION	2A
CROMWELL ROAD – SOUTH SERVICE ROAD	SOUTH-EAST	BETWEEN A POINT 209.3 METRES WEST OF ITS JUNCTION WITH AIRLIE ROAD AND A POINT 251.5 METRES WEST OF THAT JUNCTION	2A
CROMWELL ROAD – SOUTH SERVICE ROAD	SOUTH	BETWEEN A POINT 259.6 METRES WEST OF ITS JUNCTION WITH AIRLIE ROAD AND A POINT 296.3 METRES WEST OF THAT JUNCTION	2A
CROMWELL ROAD – SOUTH SERVICE ROAD	SOUTH-WEST	BETWEEN A POINT 301.7 METRES WEST OF ITS JUNCTION WITH AIRLIE ROAD AND A POINT 306.7 METRES WEST OF THAT JUNCTION	2A
CROMWELL ROAD	NORTH	BETWEEN A POINT 10.4 METRES EAST OF ITS JUNCTION WITH THE VALLEY AND A POINT 40.0 METRES EAST OF THAT JUNCTION	2A
CROMWELL ROAD	NORTH	BETWEEN A POINT 45.5 METRES EAST OF ITS JUNCTION WITH THE VALLEY AND A POINT 66.7 METRES EAST OF THAT JUNCTION	2A
CROMWELL ROAD	NORTH	BETWEEN A POINT 110.7 METRES EAST OF ITS JUNCTION WITH THE VALLEY AND A POINT 164.6 METRES EAST OF THAT JUNCTION	2A
CROMWELL ROAD	NORTH	BETWEEN A POINT 171.6 METRES EAST OF ITS JUNCTION WITH THE VALLEY AND A POINT 199.0 METRES EAST OF THAT JUNCTION	2A
CROMWELL ROAD	NORTH	BETWEEN A POINT 161.5 METRES WEST OF ITS JUNCTION WITH AIRLIE ROAD AND A POINT 138.0 METRES WEST OF THAT JUNCTION	2A
CROMWELL ROAD	NORTH	BETWEEN A POINT 62.2 METRES WEST OF ITS JUNCTION WITH AIRLIE ROAD AND A POINT 49.2 METRES WEST OF THAT JUNCTION	2A
CROMWELL ROAD	NORTH	BETWEEN A POINT 43.7 METRES WEST OF ITS JUNCTION WITH AIRLIE ROAD AND A POINT 35.0 METRES WEST OF THAT JUNCTION	2A
CROMWELL ROAD	EAST	BETWEEN A POINT 23.8 METRES NORTH OF ITS JUNCTION WITH STANMORE LANE AND A POINT 57.7 METRES SOUTH OF ITS JUNCTION WITH ST MARY STREET	2A

PHD417 – APPENDIX 2

<u>Road Name</u>	<u>Side</u>	<u>Description</u>	<u>Zone</u>
CROMWELL ROAD	EAST	BETWEEN A POINT 61.4 METRES NORTH OF ITS JUNCTION WITH STANMORE LANE AND A POINT 28.7 METRES SOUTH OF ITS JUNCTION WITH ST MARY STREET	2A
CROMWELL ROAD	EAST	BETWEEN A POINT 25.0 METRES NORTH OF ITS JUNCTION WITH ST MARY STREET AND A POINT 65.0 METRES NORTH OF THAT JUNCTION	2A
CROMWELL ROAD	SOUTH	BETWEEN A POINT 65.0 METRES EAST OF ITS WESTERLY JUNCTION WITH STUART CRESCENT AND A POINT 96.7 METRES EAST OF THAT JUNCTION	2A
CROMWELL ROAD	SOUTH	BETWEEN A POINT 125.0 METRES WEST OF ITS EASTERLY JUNCTION WITH STUART CRESCENT AND A POINT 107.0 METRES WEST OF THAT JUNCTION	2A
CROMWELL ROAD	SOUTH	BETWEEN A POINT 57.5 METRES WEST OF ITS EASTERLY JUNCTION WITH STUART CRESCENT AND A POINT 49.1 METRES WEST OF THAT JUNCTION	2A
CROMWELL ROAD	SOUTH	BETWEEN A POINT 38.0 METRES WEST OF ITS EASTERLY JUNCTION WITH STUART CRESCENT AND A POINT 27.6 METRES WEST OF THAT JUNCTION	2A
KINGS AVENUE	EAST	BETWEEN A POINT 30.4 METRES NORTH OF ITS JUNCTION WITH STANMORE LANE AND A POINT 76.0 METRES NORTH OF THAT JUNCTION	2A
KINGS AVENUE	EAST	BETWEEN A POINT 9.0 METRES NORTH OF ITS JUNCTION WITH PRINCES PLACE AND A POINT 16.0 METRES SOUTH OF ITS JUNCTION WITH STUART CRESCENT	2A
KINGS AVENUE	EAST	BETWEEN A POINT 15.0 METRES NORTH OF ITS JUNCTION WITH STUART CRESCENT AND A POINT 30.0 METRES NORTH OF THAT JUNCTION	2A
KINGS AVENUE	WEST	BETWEEN A POINT 55.0 METRES NORTH OF ITS JUNCTION WITH STANMORE LANE AND A POINT 74.0 METRES NORTH OF THAT JUNCTION	2A
KINGSLEY PLACE	NORTH-EAST	BETWEEN A POINT 15.0 METRES SOUTHEAST OF ITS JUNCTION WITH STUART CRESCENT AND A POINT 27.0 METRES SOUTHEAST OF THAT JUNCTION	2A
KINGSLEY PLACE	NORTH-EAST	BETWEEN A POINT 38.5 METRES SOUTHEAST OF ITS JUNCTION WITH STUART CRESCENT AND A POINT 45.0 METRES SOUTHEAST OF THAT JUNCTION	2A
MILNER PLACE	BOTH	BETWEEN A POINT 5.3 METRES EAST OF ITS JUNCTION WITH STUART CRESCENT AND A POINT 37.4 METRES EAST OF THAT JUNCTION	2A
PAULET PLACE - SPINE	EAST	BETWEEN A POINT 11.8 METRES SOUTH OF ITS JUNCTION WITH STUART CRESCENT AND A POINT 32.0 METRES SOUTH OF THAT JUNCTION	2A
PAULET PLACE -	EAST	BETWEEN A POINT 44.5 METRES SOUTH OF ITS	2A

PHD417 – APPENDIX 2

<u>Road Name</u>	<u>Side</u>	<u>Description</u>	<u>Zone</u>
SPINE		JUNCTION WITH STUART CRESCENT AND A POINT 50.8 METRES SOUTH OF THAT JUNCTION	
PAULET PLACE - SPINE	WEST	BETWEEN A POINT 11.8 METRES SOUTH OF ITS JUNCTION WITH STUART CRESCENT AND A POINT 38.8 METRES SOUTH OF THAT JUNCTION	2A
PRINCES PLACE - SPINE	NORTH	BETWEEN A POINT 15.7 METRES EAST OF ITS JUNCTION WITH KINGS AVENUE AND A POINT 24.4 METRES EAST OF THAT JUNCTION	2A
PRINCES PLACE - SPINE	NORTH	BETWEEN A POINT 29.6 METRES EAST OF ITS JUNCTION WITH KINGS AVENUE AND A POINT 42.8 METRES EAST OF THAT JUNCTION	2A
PRINCES PLACE - SPINE	NORTH-EAST	BETWEEN A POINT 63.3 METRES EAST OF ITS JUNCTION WITH KINGS AVENUE AND A POINT 92.0 METRES EAST OF THAT JUNCTION	2A
PRINCES PLACE - SPINE	SOUTH	BETWEEN A POINT 6.5 METRES EAST OF ITS JUNCTION WITH KINGS AVENUE AND A POINT 53.7 METRES EAST OF THAT JUNCTION	2A
PRINCES PLACE - SPUR	SOUTH	BETWEEN A POINT 66.7 METRES EAST OF ITS JUNCTION WITH KINGS AVENUE AND A POINT 81.0 METRES EAST OF THAT JUNCTION	2A
ST MARY STREET	NORTH	BETWEEN A POINT 12.7 METRES WEST OF ITS JUNCTION WITH CROMWELL ROAD AND A POINT 19.3 METRES WEST OF THAT JUNCTION	2A
ST MARY STREET	NORTH	BETWEEN A POINT 24.9 METRES WEST OF ITS JUNCTION WITH CROMWELL ROAD AND A POINT 55.2 METRES WEST OF THAT JUNCTION	2A
ST MARY STREET	NORTH	BETWEEN A POINT 55.0 METRES EAST OF ITS JUNCTION WITH CROMWELL ROAD AND A POINT 72.5 METRES EAST OF THAT JUNCTION	2A
ST MARY STREET	NORTH	BETWEEN A POINT 25.5 METRES SOUTH OF ITS JUNCTION WITH STUART CRESCENT AND A POINT 8.5 METRES SOUTH OF THAT JUNCTION	2A
ST MARY STREET	SOUTH	BETWEEN A POINT 5.3 METRES WEST OF ITS JUNCTION WITH CROMWELL ROAD AND A POINT 29.3 METRES WEST OF THAT JUNCTION	2A
ST MARY STREET	SOUTH	BETWEEN A POINT 33.3 METRES WEST OF ITS JUNCTION WITH CROMWELL ROAD AND A POINT 55.2 METRES WEST OF THAT JUNCTION	2A
ST MARY STREET	SOUTH	BETWEEN A POINT 19.2 METRES EAST OF ITS JUNCTION WITH CROMWELL ROAD AND A POINT 73.0 METRES EAST OF THAT JUNCTION	2A
STUART CRESCENT	NORTH	BETWEEN A POINT 27.0 METRES SOUTH OF ITS WESTERLY JUNCTION WITH CROMWELL ROAD AND A POINT 183.0 METRES WEST OF ITS JUNCTION WITH KINGS AVENUE	2A
STUART CRESCENT	NORTH	BETWEEN A POINT 151.5 METRES WEST OF ITS JUNCTION WITH KINGS AVENUE AND A POINT 98.0 METRES WEST OF THAT JUNCTION	2A
STUART CRESCENT	NORTH	BETWEEN A POINT 68.0 METRES WEST OF ITS JUNCTION WITH KINGS AVENUE AND A POINT 15.0	2A

<u>Road Name</u>	<u>Side</u>	<u>Description</u>	<u>Zone</u>
		METRES WEST OF THAT JUNCTION	
STUART CRESCENT	NORTH	BETWEEN A POINT 21.0 METRES EAST OF ITS JUNCTION WITH KINGS AVENUE AND A POINT 69.2 METRES NORTHEAST OF THAT JUNCTION	2A
STUART CRESCENT	NORTH	BETWEEN A POINT 93.9 METRES NORTHEAST OF ITS JUNCTION WITH KINGS AVENUE AND A POINT 141.0 METRES NORTHEAST OF THAT JUNCTION	2A
STUART CRESCENT	NORTH	BETWEEN A POINT 159.0 METRES NORTHEAST OF ITS JUNCTION WITH KINGS AVENUE AND A POINT 57.8 SOUTH OF ITS EASTERLY JUNCTION WITH CROMWELL ROAD	2A
STUART CRESCENT	NORTH	BETWEEN A POINT 51.0 METRES SOUTH OF ITS EASTERLY JUNCTION WITH CROMWELL ROAD AND A POINT 43.5 METRES SOUTH OF THAT JUNCTION	2A
STUART CRESCENT	NORTH	BETWEEN A POINT 38.0 METRES SOUTH OF ITS EASTERLY JUNCTION WITH CROMWELL ROAD AND A POINT 10.0 METRES SOUTH OF THAT JUNCTION	2A
STUART CRESCENT	SOUTH	BETWEEN A POINT 15.3 METRES SOUTHEAST OF ITS JUNCTION WITH ST MARY STREET AND A POINT 15.5 METRES WEST OF ITS JUNCTION WITH PAULET PLACE	2A
STUART CRESCENT	SOUTH	BETWEEN A POINT 16.0 METRES NORTHEAST OF ITS JUNCTION WITH KINGS AVENUE AND A POINT 15.5 METRES SOUTHWEST OF ITS JUNCTION WITH KINGSLEY PLACE	2A
STUART CRESCENT	SOUTH	BETWEEN A POINT 15.5 METRES NORTHEAST OF ITS JUNCTION WITH KINGSLEY PLACE AND A POINT 16.5 METRES SOUTH OF ITS JUNCTION WITH MILNER PLACE	2A

NEW SCHEDULE

Echelon Parking 2 Hour Limited Waiting With Permit Holders Exemption 8:00am to 6:00pm Monday to Saturday

<u>Road Name</u>	<u>Side</u>	<u>Description</u>	<u>Zone</u>
CROMWELL ROAD – NORTH SERVICE ROAD	SOUTH	BETWEEN A POINT 241.5 METRES WEST OF ITS JUNCTION WITH AIRLIE ROAD AND A POINT 257.0 METRES WEST OF THAT JUNCTION	2A
KINGSLEY PLACE	SOUTH-WEST	BETWEEN A POINT 45.0 METRES SOUTHEAST OF ITS JUNCTION WITH STUART CRESCENT AND A POINT 50.0 METRES SOUTHEAST OF THAT JUNCTION	2A
PAULET PLACE – EASTERN PARKING AREA	SOUTH-EAST	BETWEEN A POINT 72.2 METRES SOUTH OF ITS JUNCTION WITH STUART CRESCENT AND A POINT 95.0 METRES WEST OF THAT JUNCTION	2A
PAULET PLACE – SOUTHERN	BOTH	BETWEEN A POINT 82.3 METRES SOUTH OF ITS JUNCTION WITH STUART CRESCENT AND A POINT	2A

PHD417 – APPENDIX 2

<u>Road Name</u>	<u>Side</u>	<u>Description</u>	<u>Zone</u>
PARKING AREA		100.5 METRES SOUTH OF THAT JUNCTION	
PRINCES PLACE – SPUR	SOUTH	BETWEEN A POINT 81.0 METRES NORTHEAST OF ITS JUNCTION WITH KINGS AVENUE AND A POINT 88.0 METRES NORTHEAST OF THAT JUNCTION	2A
PRINCES PLACE – NORTHERN PARKING/GARAGE AREA	NORTH	BETWEEN A POINT 132.0 METRES NORTHEAST OF ITS JUNCTION WITH KINGS AVENUE AND A POINT 137.0 METRES NORTHEAST OF THAT JUNCTION	2A
PRINCES PLACE – NORTHERN PARKING/GARAGE AREA	SOUTH	BETWEEN A POINT 104.0 METRES NORTHEAST OF ITS JUNCTION WITH KINGS AVENUE AND A POINT 123.0 METRES NORTHEAST OF THAT JUNCTION	2A
ST MARY STREET	NORTH	BETWEEN A POINT 90.5 METRES SOUTHEAST OF ITS JUNCTION WITH CROMWELL ROAD AND A POINT 104.5 METRES SOUTHEAST OF THAT JUNCTION	2A

**Notice of Proposals of making of Various Road Traffic Regulation Orders
Affecting the District of Winchester City Council**

Winchester City Council as agents for Hampshire County Council proposes making the undermentioned road traffic regulation orders:-

1. THE HAMPSHIRE (VARIOUS ROADS WINCHESTER) (PARKING PLACES AND RESTRICTION OF WAITING) (CONTROLLED ZONE) (NO.2) ORDER 2012

The effect of this order will be to introduce Permit holder bays restrictions in various roads in Stanmore Winchester. Details are as follows:-

Disabled Permit Holders Only

<u>Road Name</u>	<u>Side</u>	<u>Description</u>	<u>Zone</u>
CROMWELL ROAD	NORTH	BETWEEN A POINT 43.7 METRES WEST OF ITS JUNCTION WITH AIRLIE ROAD AND A POINT 49.2 METRES WEST OF THAT JUNCTION	2A
CROMWELL ROAD	NORTH	BETWEEN A POINT 161.5 METRES WEST OF ITS JUNCTION WITH AIRLIE ROAD AND A POINT 167.8 METRES WEST OF THAT JUNCTION	2A
CROMWELL ROAD	NORTH	BETWEEN A POINT 40.0 METRES EAST OF ITS JUNCTION WITH THE VALLEY AND A POINT 45.5 METRES EAST OF THAT JUNCTION	2A
CROMWELL ROAD – SOUTH SERVICE ROAD	SOUTH-WEST	BETWEEN A POINT 296.3 METRES WEST OF ITS JUNCTION WITH AIRLIE ROAD AND A POINT 301.7 METRES WEST OF THAT JUNCTION	2A
PAULET PLACE - SPINE	EAST	BETWEEN A POINT 32.0 METRES SOUTH OF ITS JUNCTION WITH STUART CRESCENT AND A POINT 38.8 METRES SOUTH OF THAT JUNCTION	2A
PRINCES PLACE - SPINE	NORTH	BETWEEN A POINT 24.4 METRES EAST OF ITS JUNCTION WITH KINGS AVENUE AND APOINT 29.6 METRES EAST OF THAT JUNCTION	2A
PRINCES PLACE - SPINE	SOUTH	BETWEEN A POINT 53.7 METRES EAST OF ITS JUNCTION WITH KINGS AVENUE AND APOINT 59.7 METRES EAST OF THAT JUNCTION	2A
ST MARY STREET	NORTH	BETWEEN A POINT 19.3 METRES WEST OF ITS JUNCTION WITH CROMWELL	2A

<u>Road Name</u>	<u>Side</u>	<u>Description</u>	<u>Zone</u>
		ROAD AND A POINT 24.9 METRES WEST OF THAT JUNCTION.	
ST MARY STREET	SOUTH	BETWEEN A POINT 55.2 METRES WEST OF ITS JUNCTION WITH CROMWELL ROAD AND A POINT 60.0 METRES WEST OF THAT JUNCTION.	2A
STUART CRESCENT	NORTH	BETWEEN A POINT 38.0 METRES SOUTH OF ITS EASTERLY JUNCTION WITH CROMWELL ROAD AND A POINT 43.5 METRES SOUTH OF THAT JUNCTION.	2A
STUART CRESCENT	NORTH	BETWEEN A POINT 51.0 METRES SOUTH OF ITS EASTERLY JUNCTION WITH CROMWELL ROAD AND A POINT 57.8 METRES SOUTH OF THAT JUNCTION.	2A
STUART CRESCENT	NORTH	BETWEEN A POINT 69.2 METRES NORTHEAST OF ITS JUNCTION WITH KINGS AVENUE AND POINT 75.0 METRES NORTHEAST OF THAT JUNCTION	2A

SCHEDULE I Pt XVIII

2 Hour Limited Waiting 8:00am to 6:00pm Monday to Saturday

<u>Road Name</u>	<u>Side</u>	<u>Description</u>	<u>Zone</u>
STANMORE LANE	SOUTH	BETWEEN A POINT 20.6 METRES WEST OF ITS JUNCTION WITH KINGS AVENUE AND A POINT 31.7 METRES WEST OF THAT JUNCTION	*
STANMORE LANE	SOUTH	BETWEEN A POINT 46.0 METRES WEST OF ITS JUNCTION WITH KINGS AVENUE AND A POINT 75.3 METRES WEST OF THAT JUNCTION	*

No Waiting At Any Time

<u>Road Name</u>	<u>Side</u>	<u>Description</u>	<u>Zone</u>
CROMWELL ROAD	BOTH	BETWEEN ITS JUNCTION WITH STANMORE LANE AND A POINT 11.0 METES NORTH OF THAT JUNCTION	2A
CROMWELL ROAD	WEST	BETWEEN A POINT 8.7 METRES SOUTH OF ITS JUNCTION WITH ST MARY STREET AND A POINT 7.0 METRES NORTH OF THAT JUNCTION	2A
CROMWELL ROAD	WEST	BETWEEN A POINT 29.0 METRES SOUTH OF ITS JUNCTION WITH THE VALLEY AND A POINT 10.4 METRES EAST OF THAT	2A

<u>Road Name</u>	<u>Side</u>	<u>Description</u> JUNCTION	<u>Zone</u>
CROMWELL ROAD	NORTH	BETWEEN A POINT 66.7 METRES EAST OF ITS JUNCTION WITH THE VALLEY TO A POINT 110.7 METRES EAST OF THAT JUNCTION	2A
CROMWELL ROAD	NORTH	BETWEEN A POINT 164.6 METRES EAST OF ITS JUNCTION WITH THE VALLEY AND A POINT 171.6 METRES EAST OF THAT JUNCTION	2A
CROMWELL ROAD	NORTH	BETWEEN A POINT 93.6 METRES WEST OF ITS JUNCTION WITH AIRLIE ROAD AND A POINT 62.2 METRES WEST OF THAT JUNCTION	2A
CROMWELL ROAD	EAST	BETWEEN A POINT 57.7 METRES NORTH OF ITS JUNCTION WITH STANMORE LANE AND A POINT 61.4 METRES NORTH OF THAT JUNCTION	2A
CROMWELL ROAD	EAST	BETWEEN A POINT 8.7 METRES SOUTH OF ITS JUNCTION WITH ST MARY STREET AND A POINT 8.0 METRES NORTH OF THAT JUNCTION	2A
CROMWELL ROAD	EAST	BETWEEN A POINT 65.0 METRES NORTH OF ITS JUNCTION WITH ST MARY STREET AND A POINT 64.6 METRES WEST OF ITS WESTERLY JUNCTION WITH STUART CRESCENT	2A
CROMWELL ROAD	SOUTH	BETWEEN A POINT 15.7 METRES WEST OF ITS WESTERLY JUNCTION WITH STUART CRESCENT TO A POINT 11.0 METRES EAST OF THAT JUNCTION	2A
CROMWELL ROAD	SOUTH	BETWEEN A POINT 10.0 METRES WEST OF ITS EASTERLY JUNCTION WITH STUART CRESCENT AND A POINT 62.2 METRES WEST OF ITS JUNCTION WITH AIRLIE ROAD	2A
CROMWELL ROAD – NORTH SERVICE ROAD	NORTH-EAST	BETWEEN A POINT 204.3 METRES WEST OF ITS JUNCTION WITH AIRLIE ROAD AND A POINT 215.0 METRES WEST OF THAT JUNCTION	2A
CROMWELL ROAD – NORTH SERVICE ROAD	NORTH-EAST	BETWEEN A POINT 230.0 METRES WEST OF ITS JUNCTION WITH AIRLIE ROAD AND A POINT 245.5 METRES WEST OF THAT JUNCTION	2A

<u>Road Name</u>	<u>Side</u>	<u>Description</u>	<u>Zone</u>
CROMWELL ROAD – NORTH SERVICE ROAD	NORTH-WEST	BETWEEN A POINT 260.0 METRES WEST OF ITS JUNCTION WITH AIRLIE ROAD AND A POINT 274.0 METRES WEST OF THAT JUNCTION	2A
CROMWELL ROAD – NORTH SERVICE ROAD	NORTH-WEST	BETWEEN A POINT 283.0 METRES WEST OF ITS JUNCTION WITH AIRLIE ROAD AND A POINT 293.5 METRES WEST OF THAT JUNCTION	2A
CROMWELL ROAD – NORTH SERVICE ROAD	SOUTH-EAST	BETWEEN A POINT 204.3 METRES WEST OF ITS JUNCTION WITH AIRLIE ROAD AND A POINT 241.5 METRES WEST OF THAT JUNCTION	2A
CROMWELL ROAD – NORTH SERVICE ROAD	SOUTH-WEST	BETWEEN A POINT 257.0 METRES WEST OF ITS JUNCTION WITH AIRLIE ROAD AND A POINT 293.5 METRES WEST OF THAT JUNCTION	2A
CROMWELL ROAD – SOUTH SERVICE ROAD	NORTH	BETWEEN A POINT 209.3 METRES WEST OF ITS JUNCTION WITH AIRLIE ROAD AND A POINT 306.7 METRES WEST OF THAT JUNCTION	2A
CROMWELL ROAD – SOUTH SERVICE ROAD	SOUTH	BETWEEN A POINT 251.5 METRES WEST OF ITS JUNCTION WITH AIRLIE ROAD AND A POINT 259.6 METRES WEST OF THAT JUNCTION	2A
KINGS AVENUE	EAST	BETWEEN A POINT 15.2 METRES NORTH OF ITS JUNCTION WITH STUART CRESCENT TO A POINT 16.0 METRES SOUTH OF THAT JUNCTION	2A
KINGS AVENUE	EAST	BETWEEN A POINT 30.0 METRES NORTH OF ITS JUNCTION WITH STUART CRESCENT AND A POINT 38.5 METRES NORTH OF THAT JUNCTION INCLUDING THE TURNING AREA	2A
KINGS AVENUE	EAST	BETWEEN ITS JUNCTION WITH STANMORE LANE AND A POINT 30.4 METRES NORTH OF THAT JUNCTION	2A
KINGS AVENUE	EAST	BETWEEN A POINT 9.0 METRES NORTH OF ITS JUNCTION WITH PRINCES PLACE AND A POINT 13.7 METRES SOUTH OF THAT JUNCTION	2A
KINGS AVENUE	WEST	BETWEEN A POINT 38.5 METRES NORTH OF ITS JUNCTION WITH STUART CRESCENT TO A POINT 16.0 METRES SOUTH OF THAT JUNCTION INCLUDING	2A

<u>Road Name</u>	<u>Side</u>	<u>Description</u>	<u>Zone</u>
		THE TURNING AREA	
KINGS AVENUE	WEST	BETWEEN ITS JUNCTION WITH STANMORE LANE AND A POINT 55.0 METRES NORTH OF THAT JUNCTION	2A
KINGSLEY PLACE	BOTH	BETWEEN ITS JUNCTION WITH STUART CRESCENT TO A POINT 15.0 METRES SOUTHEAST OF THAT JUNCTION	2A
KINGSLEY PLACE	NORTH-EAST	BETWEEN A POINT 27.0 METRES SOUTHEAST OF ITS JUNCTION WITH STUART CRESCENT TO A POINT 38.5 METRES SOUTHEAST OF THAT JUNCTION	2A
KINGSLEY PLACE	NORTH-EAST	BETWEEN A POINT 45.0 METRES SOUTHEAST OF ITS JUNCTION WITH STUART CRESCENT TO A POINT 55.5 METRES SOUTHEAST OF THAT JUNCTION INCLUDING THE TURNING AREA	2A
KINGSLEY PLACE	SOUTH-WEST	BETWEEN A POINT 50.0 METRES SOUTHEAST OF ITS JUNCTION WITH STUART CRESCENT TO A POINT 55.5 METRES SOUTHEAST OF THAT JUNCTION INCLUDING THE TURNING AREA	2A
MILNER PLACE	BOTH	BETWEEN ITS JUNCTION WITH STUART CRESCENT TO A POINT 5.3 METRES EAST OF THAT JUNCTION	2A
OCTAVIA HILL	BOTH	BETWEEN ITS JUNCTION WITH THE VALLEY AND A POINT 7.7 METRES NORTH OF THAT JUNCTION	2A
PAULET PLACE - SPINE	BOTH	BETWEEN ITS JUNCTION WITH STUART CRESCENT TO A POINT 11.8 METRES SOUTH OF THAT JUNCTION	2A
PAULET PLACE – SOUTHERN PARKING AREA	SOUTH	ADJACENT TO REAR ACCESS OF 39 STANMORE LANE FOR A DISTANCE OF 5.0 METRES	2A
PRINCES PLACE - SPINE	NORTH	BETWEEN ITS JUNCTION WITH KINGS AVENUE AND A POINT 15.7 METRES EAST OF THAT JUNCTION	2A
PRINCES PLACE – SPINE	NORTH	BETWEEN A POINT 42.8 METRES EAST OF ITS JUNCTION WITH KINGS AVENUE AND A POINT 63.3 METRES NORTHEAST OF THAT JUNCTION	2A

<u>Road Name</u>	<u>Side</u>	<u>Description</u>	<u>Zone</u>
PRINCES PLACE - SPINE	NORTH	BETWEEN A POINT 92.0 METRES NORTHEAST OF ITS JUNCTION WITH KINGS AVENUE AND A POINT 126.0 METRES NORTHEAST OF THAT JUNCTION	2A
PRINCES PLACE - SPINE	SOUTH	BETWEEN ITS JUNCTION WITH KINGS AVENUE AND A POINT 6.5 METRES EAST OF THAT JUNCTION	2A
PRINCES PLACE - SPINE	SOUTH	BETWEEN A POINT 59.7 METRES NORTHEAST OF ITS JUNCTION WITH KINGS AVENUE AND A POINT 66.7 METRES NORTHEAST OF THAT JUNCTION	2A
PRINCES PLACE - SPINE	SOUTH-EAST	BETWEEN A POINT 88.0 METRES NORTHEAST OF ITS JUNCTION WITH KINGS AVENUE AND A POINT 104.0 METRES NORTHEAST OF THAT JUNCTION	2A
PRINCES PLACE - SPUR	NORTH	BETWEEN A POINT 88.0 METRES NORTHEAST OF ITS JUNCTION WITH KINGS AVENUE AND A POINT 108.5 METRES NORTHEAST OF THAT JUNCTION	2A
PRINCES PLACE – NORTHERN PARKING/GARAGE AREA	EAST	BETWEEN A POINT 123.0 METRES NORTHEAST OF ITS JUNCTION WITH KINGS AVENUE AND A POINT 132.0 METRES NORTHEAST OF THAT JUNCTION (A DISTANCE OF 9.0 METRES)	2A
PRINCES PLACE – NORTHERN PARKING/GARAGE AREA	SOUTH-WEST	BETWEEN A POINT 104.0 METRES NORTHEAST OF ITS JUNCTION WITH KINGS AVENUE AND A POINT 126.0 METRES NORTHEAST OF THAT JUNCTION	2A
PRINCES PLACE – EASTERN PARKING/GARAGE AREA	NORTH	BETWEEN A POINT 108.0 METRES NORTHEAST OF ITS JUNCTION WITH KINGS AVENUE AND A POINT 128.5 METRES NORTHEAST OF THAT JUNCTION	2A
PRINCES PLACE – EASTERN PARKING/GARAGE AREA	SOUTH	BETWEEN A POINT 88.0 METRES NORTHEAST OF ITS JUNCTION WITH KINGS AVENUE AND A POINT 106.0 METRES NORTHEAST OF THAT JUNCTION	2A
ST MARY	BOTH	BETWEEN ITS JUNCTION WITH STUART	2A

<u>Road Name</u>	<u>Side</u>	<u>Description</u>	<u>Zone</u>
STREET		CRESCENT AND POINT 8.5 METRES SOUTHWEST OF THAT JUNCTION	
ST MARY STREET	NORTH	BETWEEN A POINT 12.7 METRES WEST OF ITS JUNCTION WITH CROMWELL ROAD AND A POINT 19.2 EAST OF THAT JUNCTION	2A
ST MARY STREET	NORTH	BETWEEN A POINT 55.2 METRES WEST OF ITS JUNCTION WITH CROMWELL ROAD AND A POINT 66.7 METRES WEST OF THAT JUNCTION INCLUDING THE TURNING AREA	2A
ST MARY STREET	NORTH	BETWEEN A POINT 72.5 METRES EAST OF ITS JUNCTION WITH CROMWELL ROAD AND A POINT 90.5 METRES EAST OF THAT JUNCTION	2A
ST MARY STREET	NORTH	BETWEEN A POINT 104.5 METRES EAST OF ITS JUNCTION WITH CROMWELL ROAD AND A POINT 49.0 METRES SOUTHWEST OF ITS JUNCTION WITH STUART CRESCENT	2A
ST MARY STREET	SOUTH	BETWEEN A POINT 5.3 METRES WEST OF ITS JUNCTION WITH CROMWELL ROAD AND A POINT 19.2 EAST OF THAT JUNCTION	2A
ST MARY STREET	SOUTH	BETWEEN A POINT 29.3 METRES WEST OF ITS JUNCTION WITH CROMWELL ROAD AND A POINT 33.3 METRES WEST OF THAT JUNCTION	2A
ST MARY STREET	SOUTH	BETWEEN A POINT 60.0 METRES WEST OF ITS JUNCTION WITH CROMWELL ROAD AND A POINT 66.7 METRES WEST OF THAT JUNCTION INCLUDING THE TURNING AREA	2A
ST MARY STREET	SOUTH	BETWEEN A POINT 73.0 METRES EAST OF ITS JUNCTION WITH CROMWELL ROAD AND A POINT 49.0 METRES SOUTHWEST OF ITS JUNCTION WITH STUART CRESCENT	2A
STANMORE LANE	NORTH	BETWEEN ITS JUNCTION WITH KINGS AVENUE AND A POINT 100.0 METRES EAST OF THAT JUNCTION	*
STANMORE LANE	SOUTH	BETWEEN A POINT 75.3 METRES EAST OF ITS JUNCTION WITH KINGS AVENUE AND A POINT 100.0 METRES EAST OF	*

<u>Road Name</u>	<u>Side</u>	<u>Description</u>	<u>Zone</u>
		THAT JUNCTION	
STUART CRESCENT	BOTH	BETWEEN ITS WESTERLY JUNCTION WITH CROMWELL ROAD AND A POINT 27.0 METRES SOUTH OF THAT JUNCTION	2A
STUART CRESCENT	BOTH	BETWEEN ITS EASTERLY JUNCTION WITH CROMWELL ROAD AND A POINT 10.0 METRES SOUTH OF THAT JUNCTION	2A
STUART CRESCENT	NORTH	BETWEEN A POINT 183.0 METRES WEST OF ITS JUNCTION WITH KINGS AVENUE AND A POINT 151.5 METRES WEST OF THAT JUNCTION	2A
STUART CRESCENT	NORTH	BETWEEN A POINT 98.0 METRES WEST OF ITS JUNCTION WITH KINGS AVENUE AND A POINT 68.0 METRES WEST OF THAT JUNCTION	2A
STUART CRESCENT	NORTH	BETWEEN A POINT 15.0 METRES WEST OF ITS JUNCTION WITH KINGS AVENUE AND A POINT 21.0 METRES EAST OF THAT JUNCTION	2A
STUART CRESCENT	NORTH	BETWEEN A POINT 75.0 METRES NORTHEAST OF ITS JUNCTION WITH KINGS AVENUE AND A POINT 93.9 METRES NORTHEAST OF THAT JUNCTION	2A
STUART CRESCENT	NORTH	BETWEEN A POINT 141.0 METRES NORTHEAST OF ITS JUNCTION WITH KINGS AVENUE AND A POINT 159.0 METRES NORTHEAST OF THAT JUNCTION	2A
STUART CRESCENT	SOUTH	BETWEEN A POINT 10.8 METRES NORTHWEST OF ITS JUNCTION WITH ST MARY STREET AND A POINT 15.3 METRES SOUTHEAST OF THAT JUNCTION	2A
STUART CRESCENT	SOUTH	BETWEEN A POINT 15.5 METRES WEST OF ITS JUNCTION WITH PAULET PLACE AND A POINT 15.5 METRES EAST OF THAT JUNCTION	2A
STUART CRESCENT	SOUTH	BETWEEN A POINT 15.0 METRES WEST OF ITS JUNCTION WITH KINGS AVENUE AND A POINT 16.0 METRES EAST OF THAT JUNCTION	2A
STUART	SOUTH	BETWEEN A POINT 15.5 METRES	2A

<u>Road Name</u>	<u>Side</u>	<u>Description</u>	<u>Zone</u>
CRESCENT		SOUTHWEST OF ITS JUNCTION WITH KINGSLEY PLACE AND A POINT 15.5 METRES NORTHEAST OF THAT JUNCTION	
STUART CRESCENT	SOUTH	BETWEEN A POINT 16.5 METRES SOUTH OF ITS JUNCTION WITH MILNER PLACE AND A POINT 8.0 METRES NORTH OF THAT JUNCTION	2A
THE VALLEY	BOTH	BETWEEN ITS JUNCTION WITH CROMWELL ROAD AND A POINT 40.0 METRES NORTHWEST OF THAT JUNCTION	2A

No Stopping 7:00am to 7:00pm Except Buses

<u>Road Name</u>	<u>Side</u>	<u>Description</u>	<u>Zone</u>
CROMWELL ROAD	NORTH	BETWEEN A POINT 199.0 METRES EAST OF ITS JUNCTION WITH THE VALLEY AND A POINT 208.0 METRES EAST OF THAT JUNCTION	2A
CROMWELL ROAD	SOUTH	BETWEEN A POINT 11.0 METRES NORTH OF ITS JUNCTION WITH STANMORE LANE AND A POINT 23.8 METRES NORTH OF THAT JUNCTION	2A
STANMORE LANE	SOUTH	BETWEEN A POINT 31.7 METRES EAST OF ITS JUNCTION WITH KINGS AVENUE AND A POINT 46.0 METRES EAST OF THAT JUNCTION	2A

No Waiting 10:00am to 4:00pm Monday to Friday

<u>Road Name</u>	<u>Side</u>	<u>Description</u>	<u>Zone</u>
CROMWELL ROAD	NORTH	BETWEEN ITS JUNCTION WITH AIRLIE ROAD AND A POINT 35.0 METRES WEST OF THAT JUNCTION	2A
CROMWELL ROAD	NORTH	BETWEEN A POINT 93.6 METRES WEST OF ITS JUNCTION WITH AIRLIE ROAD AND A POINT 138.0 METRES WEST OF THAT JUNCTION	2A
CROMWELL ROAD	NORTH	BETWEEN A POINT 167.8 METRES WEST OF ITS JUNCTION WITH AIRLIE ROAD AND A POINT 277.9 METRES WEST OF THAT JUNCTION	2A
CROMWELL	WEST	BETWEEN A POINT 29.0 METRES SOUTH	2A

<u>Road Name</u>	<u>Side</u>	<u>Description</u>	<u>Zone</u>
ROAD		OF ITS JUNCTION WITH THE VALLEY AND A POINT 7.0 METRES NORTH OF ITS JUNCTION WITH ST MARY STREET	
CROMWELL ROAD	WEST	BETWEEN A POINT 8.7 METRES SOUTH OF ITS JUNCTION WITH ST MARY STREET AND A POINT 11.0 METRES NORTH OF ITS JUNCTION WITH STANMORE LANE	2A
CROMWELL ROAD	SOUTH	BETWEEN ITS JUNCTION WITH AIRLIE ROAD AND A POINT 62.2 METRES WEST OF THAT JUNCTION	2A
CROMWELL ROAD	SOUTH	BETWEEN A POINT 10.0 METRES WEST OF ITS EASTERLY JUNCTION WITH STUART CRESCENT AND A POINT 27.6 METRES WEST OF THAT JUNCTION	2A
CROMWELL ROAD	SOUTH	BETWEEN A POINT 38.0 METRES WEST OF ITS EASTERLY JUNCTION WITH STUART CRESCENT AND A POINT 49.1 METRES WEST OF THAT JUNCTION	2A
CROMWELL ROAD	SOUTH	BETWEEN A POINT 57.5 METRES WEST OF ITS EASTERLY JUNCTION WITH STUART CRESCENT AND A POINT 107.0 METRES WEST OF THAT JUNCTION	2A
CROMWELL ROAD	SOUTH	BETWEEN A POINT 96.7 METRES EAST OF ITS WESTERLY JUNCTION WITH STUART CRESCENT TO A POINT 125.0 METRES WEST OF ITS EASTERLY JUNCTION WITH STUART CRESCENT	2A
CROMWELL ROAD	SOUTH	BETWEEN A POINT 11.0 METRES EAST OF ITS WESTERLY JUNCTION WITH STUART CRESCENT TO A POINT 65.0 METRES EAST OF THAT JUNCTION	2A
CROMWELL ROAD	SOUTH	BETWEEN A POINT 15.7 METRES WEST OF ITS WESTERLY JUNCTION WITH STUART CRESCENT TO A POINT 64.6 METRES WEST OF THAT JUNCTION	2A
CROMWELL ROAD	EAST	BETWEEN A POINT 25.0 METRES NORTH OF ITS JUNCTION WITH ST MARY STREET AND A POINT 8.0 METRES NORTH OF THAT JUNCTION	2A
CROMWELL ROAD	EAST	BETWEEN A POINT 8.7 METRES SOUTH OF ITS JUNCTION WITH ST MARY STREET AND A POINT 28.7 METRES SOUTH OF THAT JUNCTION	2A

<u>Road Name</u>	<u>Side</u>	<u>Description</u>	<u>Zone</u>
KINGS AVENUE	EAST	BETWEEN A POINT 13.7 METRES SOUTH OF ITS JUNCTION WITH PRINCES PLACE AND A POINT 76.0 METRES NORTH OF ITS JUNCTION WITH STANMORE LANE	2A
KINGS AVENUE	WEST	BETWEEN A POINT 16.0 METRES SOUTH OF ITS JUNCTION WITH STUART CRESCENT AND A POINT 74.0 METRES NORTH OF ITS JUNCTION WITH STANMORE LANE	2A
KINGSLEY PLACE	SOUTH-WEST	BETWEEN A POINT 15.0 METRES SOUTHEAST OF ITS JUNCTION WITH STUART CRESCENT AND A POINT 45.0 METRES SOUTHEAST OF THAT JUNCTION	2A
LISLE COURT	BOTH	BETWEEN ITS JUNCTION WITH STUART CRESCENT AND A POINT 38.5 METRES EAST OF THAT JUNCTION	2A
MILNER PLACE	BOTH	BETWEEN A POINT 37.4 METRES EAST OF ITS JUNCTION WITH STUART CRESCENT TO A POINT 47.3 METRES EAST OF THAT JUNCTION INCLUDING THE TURNING AREA	2A
PAULET PLACE – SPINE	EAST	BETWEEN A POINT 38.8 METRES SOUTH OF ITS JUNCTION WITH STUART CRESCENT AND A POINT 44.5 METRES SOUTH OF THAT JUNCTION	2A
PAULET PLACE – SPINE	EAST	BETWEEN A POINT 50.8 METRES SOUTH OF ITS JUNCTION WITH STUART CRESCENT AND A POINT 72.2 METRES SOUTH OF THAT JUNCTION	2A
PAULET PLACE - SPINE	WEST	BETWEEN A POINT 38.8 METRES SOUTH OF ITS JUNCTION WITH STUART CRESCENT AND A POINT 70.0 METRES SOUTH OF THAT JUNCTION	2A
PAULET PLACE – SPUR	NORTH	BETWEEN A POINT 70.0 METRES SOUTH OF ITS JUNCTION WITH STUART CRESCENT AND A POINT 82.3 METRES SOUTH OF THAT JUNCTION	2A
PAULET PLACE - SPUR	SOUTH	BETWEEN A POINT 70.0 METRES SOUTH OF ITS JUNCTION WITH STUART CRESCENT AND A POINT 77.0 METRES SOUTH OF THAT JUNCTION	2A
ST MARY	NORTH	BETWEEN A POINT 19.2 METRES	2A

<u>Road Name</u>	<u>Side</u>	<u>Description</u>	<u>Zone</u>
STREET		SOUTHEAST OF ITS JUNCTION WITH CROMWELL ROAD AND A POINT 55.0 METRES SOUTHEAST OF THAT JUNCTION	
ST MARY STREET	NORTH	BETWEEN A POINT 49.0 METRES SOUTHWEST OF ITS JUNCTION WITH STUART CRESCENT AND A POINT 25.5 METRES SOUTHWEST OF THAT JUNCTION	2A
ST MARY STREET	SOUTH	BETWEEN A POINT 49.0 METRES SOUTHWEST OF ITS JUNCTION WITH STUART CRESCENT AND A POINT 8.5 METRES SOUTHWEST OF THAT JUNCTION	2A
STUART CRESCENT	SOUTH	BETWEEN A POINT 10.0 METRES SOUTH OF ITS EASTERLY JUNCTION WITH CROMWELL ROAD TO A POINT 8.0 METRES NORTH OF ITS JUNCTION WITH MILNER PLACE	2A
STUART CRESCENT	SOUTH	BETWEEN A POINT 15.0 METRES WEST OF ITS JUNCTION WITH KINGS AVENUE TO A POINT 11.8 METRES EAST OF ITS JUNCTION WITH PAULET PLACE	2A
STUART CRESCENT	SOUTH	BETWEEN A POINT 10.8 METRES NORTH OF ITS JUNCTION WITH ST MARY STREET TO A POINT 27.0 METRES SOUTH OF ITS WESTERLY JUNCTION WITH CROMWELL ROAD	2A

2 Hour Limited Waiting With Permit Holders Exemption 8:00am to 6:00pm
Monday to Saturday

<u>Road Name</u>	<u>Side</u>	<u>Description</u>	<u>Zone</u>
CROMWELL ROAD – NORTH SERVICE ROAD	NORTH-EAST	BETWEEN A POINT 215.0 METRES WEST OF ITS JUNCTION WITH AIRLIE ROAD AND A POINT 230.0 METRES WEST OF THAT JUNCTION	2A
CROMWELL ROAD – NORTH SERVICE ROAD	NORTH	BETWEEN A POINT 245.5 METRES WEST OF ITS JUNCTION WITH AIRLIE ROAD AND A POINT 260.0 METRES WEST OF THAT JUNCTION	2A
CROMWELL ROAD – NORTH SERVICE ROAD	NORTH-WEST	BETWEEN A POINT 274.0 METRES WEST OF ITS JUNCTION WITH AIRLIE ROAD AND A POINT 283.0 METRES WEST OF THAT JUNCTION	2A

<u>Road Name</u>	<u>Side</u>	<u>Description</u>	<u>Zone</u>
CROMWELL ROAD – SOUTH SERVICE ROAD	SOUTH-EAST	BETWEEN A POINT 209.3 METRES WEST OF ITS JUNCTION WITH AIRLIE ROAD AND A POINT 251.5 METRES WEST OF THAT JUNCTION	2A
CROMWELL ROAD – SOUTH SERVICE ROAD	SOUTH	BETWEEN A POINT 259.6 METRES WEST OF ITS JUNCTION WITH AIRLIE ROAD AND A POINT 296.3 METRES WEST OF THAT JUNCTION	2A
CROMWELL ROAD – SOUTH SERVICE ROAD	SOUTH-WEST	BETWEEN A POINT 301.7 METRES WEST OF ITS JUNCTION WITH AIRLIE ROAD AND A POINT 306.7 METRES WEST OF THAT JUNCTION	2A
CROMWELL ROAD	NORTH	BETWEEN A POINT 10.4 METRES EAST OF ITS JUNCTION WITH THE VALLEY AND A POINT 40.0 METRES EAST OF THAT JUNCTION	2A
CROMWELL ROAD	NORTH	BETWEEN A POINT 45.5 METRES EAST OF ITS JUNCTION WITH THE VALLEY AND A POINT 66.7 METRES EAST OF THAT JUNCTION	2A
CROMWELL ROAD	NORTH	BETWEEN A POINT 110.7 METRES EAST OF ITS JUNCTION WITH THE VALLEY AND A POINT 164.6 METRES EAST OF THAT JUNCTION	2A
CROMWELL ROAD	NORTH	BETWEEN A POINT 171.6 METRES EAST OF ITS JUNCTION WITH THE VALLEY AND A POINT 199.0 METRES EAST OF THAT JUNCTION	2A
CROMWELL ROAD	NORTH	BETWEEN A POINT 161.5 METRES WEST OF ITS JUNCTION WITH AIRLIE ROAD AND A POINT 138.0 METRES WEST OF THAT JUNCTION	2A
CROMWELL ROAD	NORTH	BETWEEN A POINT 62.2 METRES WEST OF ITS JUNCTION WITH AIRLIE ROAD AND A POINT 49.2 METRES WEST OF THAT JUNCTION	2A
CROMWELL ROAD	NORTH	BETWEEN A POINT 43.7 METRES WEST OF ITS JUNCTION WITH AIRLIE ROAD AND A POINT 35.0 METRES WEST OF THAT JUNCTION	2A
CROMWELL ROAD	EAST	BETWEEN A POINT 23.8 METRES NORTH OF ITS JUNCTION WITH STANMORE LANE AND A POINT 57.7 METRES SOUTH OF ITS JUNCTION WITH ST MARY STREET	2A

<u>Road Name</u>	<u>Side</u>	<u>Description</u>	<u>Zone</u>
CROMWELL ROAD	EAST	BETWEEN A POINT 61.4 METRES NORTH OF ITS JUNCTION WITH STANMORE LANE AND A POINT 28.7 METRES SOUTH OF ITS JUNCTION WITH ST MARY STREET	2A
CROMWELL ROAD	EAST	BETWEEN A POINT 25.0 METRES NORTH OF ITS JUNCTION WITH ST MARY STREET AND A POINT 65.0 METRES NORTH OF THAT JUNCTION	2A
CROMWELL ROAD	SOUTH	BETWEEN A POINT 65.0 METRES EAST OF ITS WESTERLY JUNCTION WITH STUART CRESCENT AND A POINT 96.7 METRES EAST OF THAT JUNCTION	2A
CROMWELL ROAD	SOUTH	BETWEEN A POINT 125.0 METRES WEST OF ITS EASTERLY JUNCTION WITH STUART CRESCENT AND A POINT 107.0 METRES WEST OF THAT JUNCTION	2A
CROMWELL ROAD	SOUTH	BETWEEN A POINT 57.5 METRES WEST OF ITS EASTERLY JUNCTION WITH STUART CRESCENT AND A POINT 49.1 METRES WEST OF THAT JUNCTION	2A
CROMWELL ROAD	SOUTH	BETWEEN A POINT 38.0 METRES WEST OF ITS EASTERLY JUNCTION WITH STUART CRESCENT AND A POINT 27.6 METRES WEST OF THAT JUNCTION	2A
KINGS AVENUE	EAST	BETWEEN A POINT 30.4 METRES NORTH OF ITS JUNCTION WITH STANMORE LANE AND A POINT 76.0 METRES NORTH OF THAT JUNCTION	2A
KINGS AVENUE	EAST	BETWEEN A POINT 9.0 METRES NORTH OF ITS JUNCTION WITH PRINCES PLACE AND A POINT 16.0 METRES SOUTH OF ITS JUNCTION WITH STUART CRESCENT	2A
KINGS AVENUE	EAST	BETWEEN A POINT 15.0 METRES NORTH OF ITS JUNCTION WITH STUART CRESCENT AND A POINT 30.0 METRES NORTH OF THAT JUNCTION	2A
KINGS AVENUE	WEST	BETWEEN A POINT 55.0 METRES NORTH OF ITS JUNCTION WITH STANMORE LANE AND A POINT 74.0 METRES NORTH OF THAT JUNCTION	2A
KINGSLEY PLACE	NORTH-EAST	BETWEEN A POINT 15.0 METRES SOUTHEAST OF ITS JUNCTION WITH STUART CRESCENT AND A POINT 27.0	2A

<u>Road Name</u>	<u>Side</u>	<u>Description</u>	<u>Zone</u>
		METRES SOUTHEAST OF THAT JUNCTION	
KINGSLEY PLACE	NORTH-EAST	BETWEEN A POINT 38.5 METRES SOUTHEAST OF ITS JUNCTION WITH STUART CRESCENT AND A POINT 45.0 METRES SOUTHEAST OF THAT JUNCTION	2A
MILNER PLACE	BOTH	BETWEEN A POINT 5.3 METRES EAST OF ITS JUNCTION WITH STUART CRESCENT AND A POINT 37.4 METRES EAST OF THAT JUNCTION	2A
PAULET PLACE - SPINE	EAST	BETWEEN A POINT 11.8 METRES SOUTH OF ITS JUNCTION WITH STUART CRESCENT AND A POINT 32.0 METRES SOUTH OF THAT JUNCTION	2A
PAULET PLACE - SPINE	EAST	BETWEEN A POINT 44.5 METRES SOUTH OF ITS JUNCTION WITH STUART CRESCENT AND A POINT 50.8 METRES SOUTH OF THAT JUNCTION	2A
PAULET PLACE - SPINE	WEST	BETWEEN A POINT 11.8 METRES SOUTH OF ITS JUNCTION WITH STUART CRESCENT AND A POINT 38.8 METRES SOUTH OF THAT JUNCTION	2A
PRINCES PLACE - SPINE	NORTH	BETWEEN A POINT 15.7 METRES EAST OF ITS JUNCTION WITH KINGS AVENUE AND A POINT 24.4 METRES EAST OF THAT JUNCTION	2A
PRINCES PLACE - SPINE	NORTH	BETWEEN A POINT 29.6 METRES EAST OF ITS JUNCTION WITH KINGS AVENUE AND A POINT 42.8 METRES EAST OF THAT JUNCTION	2A
PRINCES PLACE - SPINE	NORTH-EAST	BETWEEN A POINT 63.3 METRES EAST OF ITS JUNCTION WITH KINGS AVENUE AND A POINT 92.0 METRES EAST OF THAT JUNCTION	2A
PRINCES PLACE - SPINE	SOUTH	BETWEEN A POINT 6.5 METRES EAST OF ITS JUNCTION WITH KINGS AVENUE AND A POINT 53.7 METRES EAST OF THAT JUNCTION	2A
PRINCES PLACE - SPUR	SOUTH	BETWEEN A POINT 66.7 METRES EAST OF ITS JUNCTION WITH KINGS AVENUE AND A POINT 81.0 METRES EAST OF THAT JUNCTION	2A

<u>Road Name</u>	<u>Side</u>	<u>Description</u>	<u>Zone</u>
ST MARY STREET	NORTH	BETWEEN A POINT 12.7 METRES WEST OF ITS JUNCTION WITH CROMWELL ROAD AND A POINT 19.3 METRES WEST OF THAT JUNCTION	2A
ST MARY STREET	NORTH	BETWEEN A POINT 24.9 METRES WEST OF ITS JUNCTION WITH CROMWELL ROAD AND A POINT 55.2 METRES WEST OF THAT JUNCTION	2A
ST MARY STREET	NORTH	BETWEEN A POINT 55.0 METRES EAST OF ITS JUNCTION WITH CROMWELL ROAD AND A POINT 72.5 METRES EAST OF THAT JUNCTION	2A
ST MARY STREET	NORTH	BETWEEN A POINT 25.5 METRES SOUTH OF ITS JUNCTION WITH STUART CRESCENT AND A POINT 8.5 METRES SOUTH OF THAT JUNCTION	2A
ST MARY STREET	SOUTH	BETWEEN A POINT 5.3 METRES WEST OF ITS JUNCTION WITH CROMWELL ROAD AND A POINT 29.3 METRES WEST OF THAT JUNCTION	2A
ST MARY STREET	SOUTH	BETWEEN A POINT 33.3 METRES WEST OF ITS JUNCTION WITH CROMWELL ROAD AND A POINT 55.2 METRES WEST OF THAT JUNCTION	2A
ST MARY STREET	SOUTH	BETWEEN A POINT 19.2 METRES EAST OF ITS JUNCTION WITH CROMWELL ROAD AND A POINT 73.0 METRES EAST OF THAT JUNCTION	2A
STUART CRESCENT	NORTH	BETWEEN A POINT 27.0 METRES SOUTH OF ITS WESTERLY JUNCTION WITH CROMWELL ROAD AND A POINT 183.0 METRES WEST OF ITS JUNCTION WITH KINGS AVENUE	2A
STUART CRESCENT	NORTH	BETWEEN A POINT 151.5 METRES WEST OF ITS JUNCTION WITH KINGS AVENUE AND A POINT 98.0 METRES WEST OF THAT JUNCTION	2A
STUART CRESCENT	NORTH	BETWEEN A POINT 68.0 METRES WEST OF ITS JUNCTION WITH KINGS AVENUE AND A POINT 15.0 METRES WEST OF THAT JUNCTION	2A
STUART CRESCENT	NORTH	BETWEEN A POINT 21.0 METRES EAST OF ITS JUNCTION WITH KINGS AVENUE AND A POINT 69.2 METRES NORTHEAST	2A

<u>Road Name</u>	<u>Side</u>	<u>Description</u> OF THAT JUNCTION	<u>Zone</u>
STUART CRESCENT	NORTH	BETWEEN A POINT 93.9 METRES NORTHEAST OF ITS JUNCTION WITH KINGS AVENUE AND A POINT 141.0 METRES NORTHEAST OF THAT JUNCTION	2A
STUART CRESCENT	NORTH	BETWEEN A POINT 159.0 METRES NORTHEAST OF ITS JUNCTION WITH KINGS AVENUE AND A POINT 57.8 SOUTH OF ITS EASTERLY JUNCTION WITH CROMWELL ROAD	2A
STUART CRESCENT	NORTH	BETWEEN A POINT 51.0 METRES SOUTH OF ITS EASTERLY JUNCTION WITH CROMWELL ROAD AND A POINT 43.5 METRES SOUTH OF THAT JUNCTION	2A
STUART CRESCENT	NORTH	BETWEEN A POINT 38.0 METRES SOUTH OF ITS EASTERLY JUNCTION WITH CROMWELL ROAD AND A POINT 10.0 METRES SOUTH OF THAT JUNCTION	2A
STUART CRESCENT	SOUTH	BETWEEN A POINT 15.3 METRES SOUTHEAST OF ITS JUNCTION WITH ST MARY STREET AND A POINT 15.5 METRES WEST OF ITS JUNCTION WITH PAULET PLACE	2A
STUART CRESCENT	SOUTH	BETWEEN A POINT 16.0 METRES NORTHEAST OF ITS JUNCTION WITH KINGS AVENUE AND A POINT 15.5 METRES SOUTHWEST OF ITS JUNCTION WITH KINGSLEY PLACE	2A
STUART CRESCENT	SOUTH	BETWEEN A POINT 15.5 METRES NORTHEAST OF ITS JUNCTION WITH KINGSLEY PLACE AND A POINT 16.5 METRES SOUTH OF ITS JUNCTION WITH MILNER PLACE	2A

Echelon Parking 2 Hour Limited Waiting With Permit Holders Exemption
8:00am to 6:00pm Monday to Saturday

<u>Road Name</u>	<u>Side</u>	<u>Description</u>	<u>Zone</u>
CROMWELL ROAD – NORTH SERVICE ROAD	SOUTH	BETWEEN A POINT 241.5 METRES WEST OF ITS JUNCTION WITH AIRLIE ROAD AND A POINT 257.0 METRES WEST OF THAT JUNCTION	2A
KINGSLEY PLACE	SOUTH- WEST	BETWEEN A POINT 45.0 METRES SOUTHEAST OF ITS JUNCTION WITH	2A

<u>Road Name</u>	<u>Side</u>	<u>Description</u>	<u>Zone</u>
		STUART CRESCENT AND A POINT 50.0 METRES SOUTHEAST OF THAT JUNCTION	
PAULET PLACE – EASTERN PARKING AREA	SOUTH-EAST	BETWEEN A POINT 72.2 METRES SOUTH OF ITS JUNCTION WITH STUART CRESCENT AND A POINT 95.0 METRES WEST OF THAT JUNCTION	2A
PAULET PLACE – SOUTHERN PARKING AREA	BOTH	BETWEEN A POINT 82.3 METRES SOUTH OF ITS JUNCTION WITH STUART CRESCENT AND A POINT 100.5 METRES SOUTH OF THAT JUNCTION	2A
PRINCES PLACE – SPUR	SOUTH	BETWEEN A POINT 81.0 METRES NORTHEAST OF ITS JUNCTION WITH KINGS AVENUE AND A POINT 88.0 METRES NORTHEAST OF THAT JUNCTION	2A
PRINCES PLACE – NORTHERN PARKING/GARAGE AREA	NORTH	BETWEEN A POINT 132.0 METRES NORTHEAST OF ITS JUNCTION WITH KINGS AVENUE AND A POINT 137.0 METRES NORTHEAST OF THAT JUNCTION	2A
PRINCES PLACE – NORTHERN PARKING/GARAGE AREA	SOUTH	BETWEEN A POINT 104.0 METRES NORTHEAST OF ITS JUNCTION WITH KINGS AVENUE AND A POINT 123.0 METRES NORTHEAST OF THAT JUNCTION	2A
ST MARY STREET	NORTH	BETWEEN A POINT 90.5 METRES SOUTHEAST OF ITS JUNCTION WITH CROMWELL ROAD AND A POINT 104.5 METRES SOUTHEAST OF THAT JUNCTION	2A

FURTHER DETAILS: A copy of this notice, the proposed orders, and maps showing the location and effect of the proposals, a statement of reasons and the order to be varied may be inspected during usual office hours at the following place:-

- (i) City Offices, Colebrook Street, Winchester.

OBJECTIONS: All objections and other representations in respect of this proposal must be sent in writing to the undersigned by 6th June 2012.
All objections must state the grounds on which they are made.

Dated this 2nd day of May 2012
H. N. Bone, Head of Legal Services
Winchester City Council, City Offices, Colebrook Street, Winchester, Hampshire.

**Notice of Proposals of making of Various Road Traffic Regulation Orders
Affecting the District of Winchester City Council**

Winchester City Council as agents for Hampshire County Council proposes making the undermentioned road traffic regulation orders:-

1. THE HAMPSHIRE (VARIOUS ROADS WINCHESTER) (PARKING PLACES AND RESTRICTION OF WAITING) (CONTROLLED ZONE) (NO.2) ORDER 2012

The effect of this order will be to introduce Permit holder bays and other restrictions in various roads in Stanmore Winchester. Summary of restrictions and roads affected are as follows:-

Disabled Permit Holders Only

CROMWELL ROAD	CROMWELL ROAD – SOUTH SERVICE ROAD	PAULET PLACE	ST MARY STREET	STUART CRESCENT
---------------	------------------------------------	--------------	----------------	-----------------

2 Hour Limited Waiting 8:00am to 6:00pm Monday to Saturday

STANMORE LANE

No Waiting At Any Time

CROMWELL ROAD	CROMWELL ROAD – NORTH SERVICE ROAD	CROMWELL ROAD – SOUTH SERVICE ROAD	KINGS AVENUE	KINGSLEY PLACE
MILNER PLACE	OCTAVIA HILL	PAULET PLACE	PAULET PLACE – PARKING AREAS	PRINCES PLACE
PRINCES PLACE – PARKING/GARAGE AREAS	ST MARY STREET	STANMORE LANE	STUART CRESCENT	THE VALLEY

No Stopping 7:00am to 7:00pm Except Buses

CROMWELL ROAD	STANMORE LANE
---------------	---------------

No Waiting 10:00am to 4:00pm Monday to Friday

CROMWELL ROAD	KINGS AVENUE	KINGSLEY PLACE	LISLE COURT	MILNER PLACE
PAULET PLACE	ST MARY STREET	STUART CRESCENT		

2 Hour Limited Waiting With Permit Holders Exemption 8:00am to 6:00pm Monday to Saturday

CROMWELL ROAD – NORTH SERVICE ROAD	CROMWELL ROAD – SOUTH SERVICE ROAD	CROMWELL ROAD	KINGS AVENUE	KINGSLEY PLACE
MILNER PLACE	PAULET PLACE	PRINCES PLACE	ST MARY STREET	STUART CRESCENT

Echelon Parking 2 Hour Limited Waiting With Permit Holders Exemption 8:00am to 6:00pm Monday to Saturday

CROMWELL ROAD – NORTH SERVICE ROAD	KINGSLEY PLACE	PAULET PLACE – PARKING AREAS	PRINCES PLACE	PRINCES PLACE – PARKING/GARAGE AREAS
------------------------------------	----------------	------------------------------	---------------	--------------------------------------

ST MARY STREET

FURTHER DETAILS: A copy of this notice, a copy of the full schedules, the proposed order, and map showing the location and effect of the proposal, a statement of reasons and the order to be varied may be inspected during usual office hours at the following place:-

- (i) City Offices, Colebrook Street, Winchester.

OBJECTIONS: All objections and other representations in respect of this proposal must be sent in writing to the undersigned by 6th June 2012. All objections must state the grounds on which they are made.

Dated this 2nd day of May 2012

H. N. Bone, Head of Legal Services

Winchester City Council, City Offices, Colebrook Street, Winchester, Hampshire.