

Local Plan Part 2 Sites Submitted - New Alresford

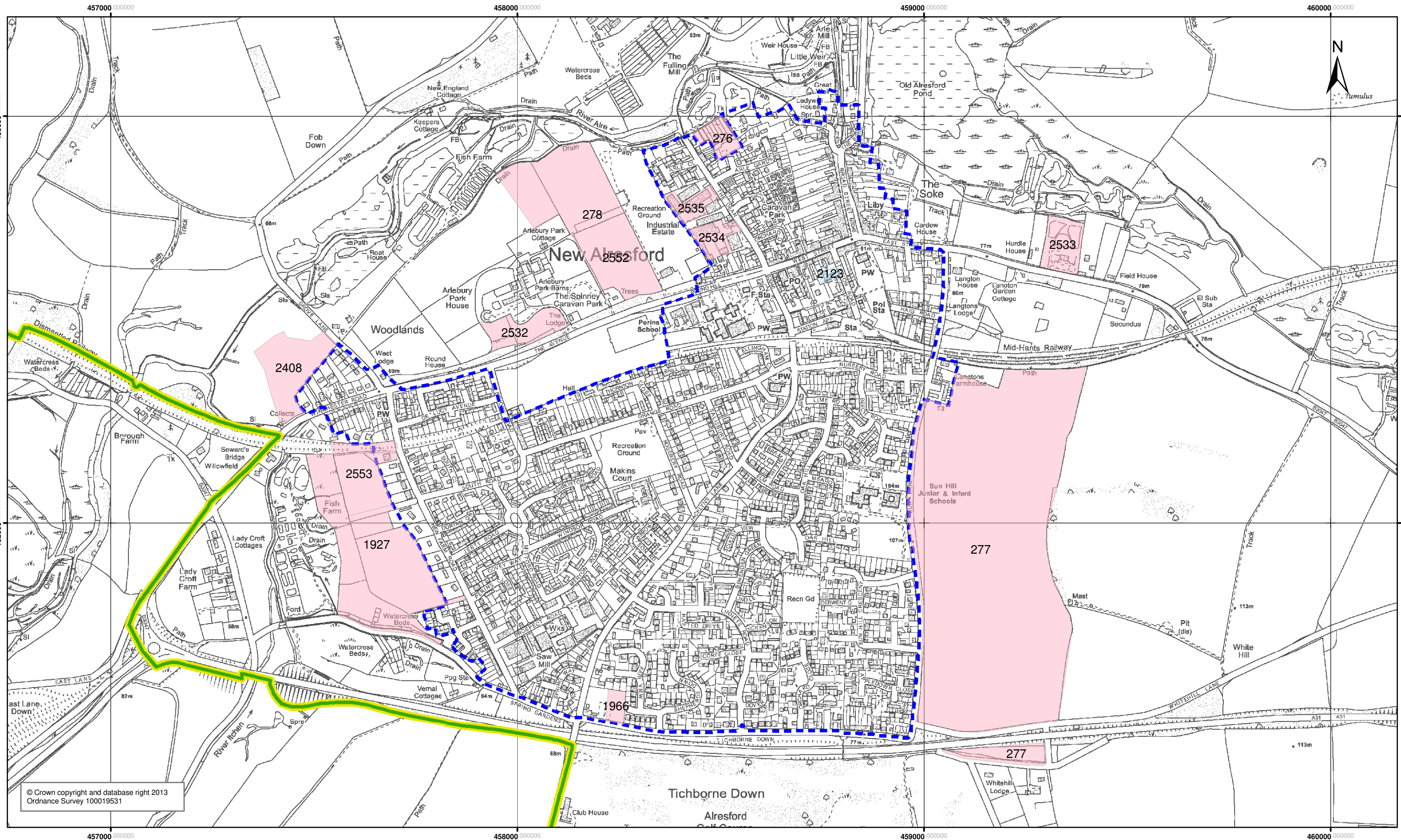

© Crown copyright and database right 2013
Ordnance Survey 100019531

Local Plan Part 2 Sites Submitted showing sites no longer under consideration for one or more of the following reasons

- Sites which are under 0.3 hectares;
- Sites within the current boundaries of settlements listed in policy MTRA 3 of the Local Plan Part 1 (these sites may be able to be brought forward for development/ redevelopment under current planning policy);
- Sites which are distant from the settlements of Winchester Town, New Alresford, Bishops Waltham, Kings Worthy, Colden Common, Swanmore, Waltham Chase, Wickham, or Denmead.
- Sites within the South Downs National Park (if the site is adjacent to one of the settlements listed above then Winchester City Council may approach the National Park if it is considered that the site is more suitable for allocation than alternative sites outside of the National Park).

Site under consideration
 Site not under consideration
 Settlement Boundaries
 South Downs National Park

The other sites will be short-listed in due course to determine which should be allocated in Local Plan Part 2